

KX INOX

**STEEL FLANGES
PRODUCT CATALOGUE
ANSI STANDARD**



Product

TYPE	STANDARD	PRESSURE CLASS	
SLIP- ON FLANGE (RAISED FACE)	ASME / ANSI B16.5	150#, 300#, 600#, 900#, 1500#, 2500#	1-3
BLIND FLANGE (RAISED FACE)	ASME / ANSI B16.5	150#, 300#, 600#, 900#, 1500#, 2500#	4-6
SOCKET WELDING FLANGE (RAISED FACE)	ASME / ANSI B16.5	150#, 300#, 600#, 1500#	7-10
THREADED FLANGE (RAISED FACE)	ASME / ANSI B16.5	150#, 300#, 600#, 900#, 1500#, 2500#	11-13
WELDING NECK (RAISED FACE)	ASME / ANSI B16.5	150#, 300#, 600#, 900#, 1500#, 2500#	14-19
SLIP-ON LAP JOINT FLANGE	ASME / ANSI B16.5	150#, 300#, 600#, 900#, 1500#, 2500#	20-22
RING JOINT DIMENSIONS	ASME / ANSI B16.5	150#, 300#, 600#, 900#, 1500#, 2500#	23-25

Dimensional Tolerance For Flanges

26

Forged Stainless Steel Flanges – ANSI

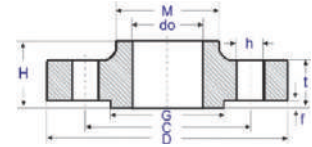

ANSI /ASTM STANDARD – 150# SORF

SLIP- ON FLANGE (RAISED FACE)

Nominal Pipe Size	Outside Dia. (mm)	Dia. of Bore (mm)	Thickness Min. (mm)	Length Thru. Hub (mm)	Dia. at Base of Hub (mm)	Dia. of Raised Face (mm)	Height of Raised Face (mm)	Number of Bolt Holes	Dia. of Bolt Holes (mm)	Dia. of Bolt Circle (mm)	Approx. Weight (KG)
	D	do	t	H	M	G	f		h	C	
1/2"	88.9	22.4	11.2	15.7	30.2	35.1	1.6	4	15.7	60.5	0.4
3/4"	98.6	27.7	12.7	15.7	38.1	42.9	1.6	4	15.7	69.9	0.6
1"	108.0	34.5	14.2	17.5	49.3	50.8	1.6	4	15.7	79.2	0.8
1.1/4"	117.3	43.5	15.7	20.6	58.7	63.5	1.6	4	15.7	88.9	1.0
1.1/2"	127.0	49.5	17.5	22.4	65.0	73.2	1.6	4	15.7	98.6	1.4
2"	152.4	62.0	19.1	25.4	77.7	91.9	1.6	4	19.1	120.7	2.1
2.1/2"	177.8	74.7	22.4	28.4	90.4	104.6	1.6	4	19.1	139.7	3.3
3"	190.5	90.7	23.9	30.2	108.0	127.0	1.6	4	19.1	152.4	3.9
3.1/2"	215.9	103.4	23.9	31.8	122.2	139.7	1.6	8	19.1	117.8	4.9
4"	228.6	116.1	23.9	33.3	134.9	157.2	1.6	8	19.1	190.5	5.4
5"	254.0	143.8	23.9	36.6	163.6	185.7	1.6	8	22.4	215.9	6.1
6"	279.4	170.7	25.4	39.6	192.0	215.9	1.6	8	22.4	241.3	7.5
8"	342.9	221.5	28.4	44.5	246.1	269.7	1.6	8	22.4	298.5	12.1
10"	406.4	276.4	30.2	49.3	304.8	323.9	1.6	12	25.4	362.0	16.5
12"	482.6	327.2	31.8	55.6	365.3	381.0	1.6	12	25.4	431.8	27.0
14"	533.4	359.2	35.1	57.2	400.1	412.8	1.6	12	28.4	476.2	35.0
16"	596.9	410.5	36.6	63.5	457.2	469.9	1.6	16	28.4	539.8	45.0
18"	365.0	461.8	39.6	68.3	505.0	533.4	1.6	16	31.8	577.9	49.0
20"	698.5	513.1	42.9	73.2	558.8	584.2	1.6	20	31.8	635.0	62.0
22"	749.3	564.4	46.0	79.4	609.6	641.2	1.6	20	35.1	692.1	85.0
24"	812.8	616.0	47.8	82.6	663.4	692.2	1.6	20	35.1	749.3	87.0

ANSI /ASTM STANDARD – 300# SORF

SLIP- ON FLANGE (RAISED FACE)

Nominal Pipe Size	Outside Dia. (mm)	Dia. of Bore (mm)	Thickness Min. (mm)	Length Thru. Hub (mm)	Dia. at Base of Hub (mm)	Dia. of Raised Face (mm)	Height of Raised Face (mm)	Number of Bolt Holes	Dia. of Bolt Holes (mm)	Dia. of Bolt Circle (mm)	Approx. Weight (KG)
	D	do	t	H	M	G	f		h	C	
1/2"	95.2	22.4	14.2	22.3	38.1	35.0	1.6	4	15.7	66.5	0.7
3/4"	117.3	27.7	15.7	25.4	47.7	42.9	1.6	4	19.0	82.5	1.2
1"	123.9	34.5	17.5	26.9	35.8	50.8	1.6	4	19.0	88.9	1.4
1.1/4"	133.3	43.5	19.0	26.9	63.5	63.5	1.6	4	19.0	98.5	1.7
1.1/2"	155.4	49.5	20.6	30.2	69.8	73.1	1.6	4	22.3	114.3	2.5
2"	165.1	62.0	22.3	33.2	84.0	91.9	1.6	8	19.0	127.0	2.9
2.1/2"	190.5	74.7	25.4	38.1	100.0	104.6	1.6	8	22.3	149.3	4.4
3"	209.5	90.7	28.4	42.9	117.3	127.0	1.6	8	22.3	168.1	5.6
3.1/2"	228.6	103.4	30.2	44.4	133.3	139.7	1.6	8	22.3	184.1	7.4
4"	254.0	116.1	31.7	47.7	146.0	157.2	1.6	8	22.3	200.1	10.0
5"	279.4	143.8	35.0	50.8	177.8	185.6	1.6	8	22.3	234.9	12.3
6"	317.5	170.7	36.5	52.3	206.2	215.9	1.6	12	22.3	269.7	15.6
8"	381.0	221.5	41.1	61.9	260.3	269.7	1.6	12	25.4	330.2	24.2
10"	444.5	276.3	47.7	66.5	320.5	323.8	1.6	16	28.4	387.3	34.1
12"	520.7	327.1	50.8	73.1	374.6	381.0	1.6	16	31.7	450.8	50.0
14"	584.2	359.1	53.8	76.2	425.4	412.7	1.6	20	31.7	514.3	70.0
16"	647.7	410.5	57.1	82.5	482.6	469.9	1.6	20	35.0	571.5	89.0
18"	711.2	461.8	60.4	88.9	533.4	533.4	1.6	24	35.0	628.6	109.0
20"	774.7	513.1	63.5	95.2	587.2	584.2	1.6	24	35.0	685.8	134.0
22"	838.2	564.4	66.7	101.6	641.2	641.2	1.6	24	41.1	742.9	168.8
24"	914.4	615.9	69.8	106.4	701.5	692.2	1.6	24	41.1	812.8	201.0

Forged Stainless Steel Flanges – ANSI

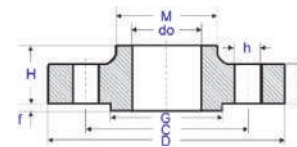

SLIP- ON FLANGE

ANSI /ASTM STANDARD – 600# SORF

SLIP- ON FLANGE (RAISED FACE)

Nominal Pipe Size	Outside Dia. (mm)	Dia. of Bore (mm)	Thickness Min. (mm)	Length Thru. Hub (mm)	Dia. at Base of Hub (mm)	Dia. of Raised Face (mm)	Height of Raised Face (mm)	Number of Bolt Holes	Dia. of Bolt Holes (mm)	Dia. of Bolt Circle (mm)	Approx. Weight (KG)
	D	do	t	H	M	G	f		h	C	
1/2"	95.3	22.4	14.2	22.4	38.1	35.1	6.4	4	15.7	66.5	0.8
3/4"	117.3	27.7	15.7	25.4	47.8	42.9	6.4	4	19.1	82.6	1.3
1"	124.0	34.5	17.5	26.9	53.8	50.8	6.4	4	19.1	88.9	1.6
1.1/4"	133.4	43.2	20.6	28.4	63.5	63.5	6.4	4	19.1	98.6	2.1
1.1/2"	155.4	49.5	22.4	31.8	69.9	73.2	6.4	4	22.4	114.3	3.0
2"	165.1	62.9	25.4	36.6	84.1	91.9	6.4	8	19.1	127.0	3.6
2.1/2"	190.5	74.7	28.4	41.1	100.1	104.6	6.4	8	22.4	149.4	5.3
3"	209.6	90.7	31.8	46.0	117.3	127.0	6.4	8	22.4	168.1	7.0
3.1/2"	228.6	103.4	35.1	49.3	133.4	139.7	6.4	8	25.4	184.2	9.0
4"	273.1	116.1	38.1	53.8	152.4	157.2	6.4	8	25.4	215.9	14.5
5"	330.2	143.8	44.5	60.5	189.0	185.7	6.4	8	28.4	266.7	25.0
6"	355.6	170.7	47.8	66.5	222.3	215.9	6.4	12	28.4	292.1	29.0
8"	419.1	221.5	55.6	76.2	273.1	269.7	6.4	12	31.8	349.3	44.0
10"	508.0	276.4	63.5	85.9	342.9	323.9	6.4	16	35.1	431.8	71.0
12"	558.8	327.2	66.5	91.9	400.1	381.0	6.4	20	35.1	489.0	85.0
14"	603.3	359.2	69.9	93.7	431.8	412.8	6.4	20	38.1	527.1	99.0
16"	685.8	410.5	76.2	106.4	495.3	469.9	6.4	20	41.1	603.3	142.0
18"	743.0	461.8	82.6	117.3	546.1	533.4	6.4	20	44.5	654.1	173.0
20"	812.8	513.1	88.9	127.0	609.6	584.2	6.4	24	44.5	723.9	220.0
22"	869.9	564.4	95.2	133.3	666.7	641.2	6.4	24	47.6	777.9	300.0
24"	939.8	616.0	101.6	139.7	717.6	692.2	6.4	24	50.8	838.2	312.0

ANSI /ASTM STANDARD – 900# SORF

SLIP- ON FLANGE (RAISED FACE)

Nominal Pipe Size	Outside Dia. (mm)	Dia. of Bore (mm)	Thickness Min. (mm)	Length Thru. Hub (mm)	Dia. at Base of Hub (mm)	Dia. of Raised Face (mm)	Height of Raised Face (mm)	Number of Bolt Holes	Dia. of Bolt Holes (mm)	Dia. of Bolt Circle (mm)	Approx. Weight (KG)
	D	do	t	H	M	G	f		h	C	
1/2"	120.6	22.3	22.3	31.7	38.1	35.0	6.4	4	22.3	82.5	1.8
3/4"	130.0	27.7	25.4	35.0	44.4	42.9	6.4	4	22.3	88.9	2.4
1"	149.3	34.5	28.4	41.1	52.3	50.8	6.4	4	25.4	101.6	3.5
1.1/4"	158.7	43.2	28.4	41.1	63.5	63.5	6.4	4	25.4	111.2	4.0
1.1/2"	177.8	49.5	31.7	44.5	69.8	73.1	6.4	4	28.4	123.9	5.4
2"	215.9	62.0	38.1	57.1	104.6	91.9	6.4	8	25.4	165.1	10.0
2.1/2"	244.3	74.7	41.1	63.5	123.9	104.6	6.4	8	28.4	190.5	14.0
3"	241.3	90.7	38.1	53.8	127.0	127.0	6.4	8	25.4	190.5	12.0
4"	292.1	116.1	44.4	69.8	158.7	157.2	6.4	8	31.7	234.9	20.0
5"	349.2	143.8	50.8	79.2	190.5	185.6	6.4	8	35.0	279.4	32.0
6"	381.0	170.7	55.6	85.8	234.9	215.9	6.4	12	31.7	317.5	42.0
8"	469.9	221.5	63.5	101.6	298.4	269.7	6.4	12	38.1	393.7	71.0
10"	546.1	276.3	69.8	107.9	368.3	323.8	6.4	16	38.1	469.9	101.0
12"	609.6	327.1	79.2	117.3	419.1	381.0	6.4	20	38.1	533.4	133.0
14"	641.3	359.1	85.8	130.0	450.8	412.7	6.4	20	41.1	558.8	153.0
16"	704.8	410.5	88.9	133.3	508.0	469.9	6.4	20	44.4	615.9	185.0
18"	787.4	461.8	101.6	152.4	565.1	533.4	6.4	20	50.8	685.8	258.0
20"	857.2	513.1	107.9	158.7	622.3	584.2	6.4	20	53.8	749.3	317.0
24"	1041.4	615.9	139.7	203.2	749.3	692.1	6.4	20	66.5	901.7	606.0

Forged Stainless Steel Flanges – ANSI

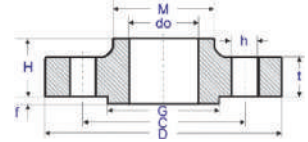

ANSI /ASTM STANDARD – 1500# SORF

SLIP- ON FLANGE (RAISED FACE)

Nominal Pipe Size	Outside Dia. (mm)	Dia. of Bore (mm)	Thickness Min. (mm)	Length Thru. Hub (mm)	Dia. at Base of Hub (mm)	Dia. of Raised Face (mm)	Height of Raised Face (mm)	Number of Bolt Holes	Dia. of Bolt Holes (mm)	Dia. of Bolt Circle (mm)	Approx. Weight (KG)
	D	do	t	H	M	G	f		h	C	
1/2"	120.6	22.3	22.3	31.7	38.1	35.0	6.4	4	22.3	82.5	1.8
3/4"	130.0	27.7	25.4	35.0	44.4	42.9	6.4	4	22.3	88.9	2.4
1"	149.3	34.5	28.4	41.1	52.3	50.8	6.4	4	25.4	101.6	3.5
1.1/4"	158.7	43.2	28.4	41.1	63.5	63.5	6.4	4	25.4	111.2	4.0
1.1/2"	177.8	49.5	31.7	44.5	69.8	73.1	6.4	4	28.4	123.9	5.4
2"	215.9	62.0	38.1	57.1	104.6	91.9	6.4	8	25.4	165.1	10.0
2.1/2"	244.3	74.7	41.1	63.5	123.9	104.6	6.4	8	28.4	190.5	14.0
3"	266.7	90.7	47.7	73.1	133.3	127.0	6.4	8	31.7	203.2	21.5
4"	311.1	116.1	53.8	90.5	162.0	157.2	6.4	8	35.0	241.3	33.2
5"	374.6	143.8	73.1	104.8	196.8	185.6	6.4	8	41.1	292.1	60.8
6"	393.7	170.7	82.5	119.1	228.6	215.9	6.4	12	38.1	317.5	74.8
8"	482.6	221.5	91.9	142.9	292.1	269.7	6.4	12	44.4	393.7	118.0
10"	584.2	276.3	107.9	158.7	368.3	323.8	6.4	12	50.8	482.6	197.0
12"	673.1	327.1	123.9	181.0	450.8	381.0	6.4	16	53.8	571.5	264.0
14"	749.3	359.1	133.3	241.3	495.3	412.7	6.4	16	60.4	635.0	404.0
16"	825.5	410.5	146.0	260.3	552.4	469.9	6.4	16	66.5	704.8	522.0
18"	914.4	461.8	162.0	276.2	596.9	533.4	6.4	16	73.1	774.7	669.0
20"	984.2	513.1	177.8	292.1	641.3	584.2	6.4	16	79.2	831.8	805.0
24"	1168.4	615.9	203.2	330.2	762.0	692.1	6.4	16	91.9	990.6	1326.0

ANSI /ASTM STANDARD – 2500# SORF

SLIP- ON FLANGE (RAISED FACE)

Nominal Pipe Size	Outside Dia. (mm)	Dia. of Bore (mm)	Thickness Min. (mm)	Length Thru. Hub (mm)	Dia. at Base of Hub (mm)	Dia. of Raised Face (mm)	Height of Raised Face (mm)	Number of Bolt Holes	Dia. of Bolt Holes (mm)	Dia. of Bolt Circle (mm)	Approx. Weight (KG)
	D	do	t	H	M	G	f		h	C	
1/2"	133.4	22.3	30.2	39.7	42.9	35.1	6.4	4	22.4	88.9	3.0
3/4"	139.7	27.7	31.8	42.9	50.8	42.9	6.4	4	22.4	95.3	3.5
1"	158.8	34.5	35.1	47.6	57.2	50.8	6.4	4	25.4	108.0	4.9
1.1/4"	184.2	43.2	38.1	52.4	73.2	63.5	6.4	4	28.4	130.0	7.2
1.1/2"	203.2	49.5	44.5	60.3	79.2	73.2	6.4	4	31.8	146.1	10.1
2"	235.0	62.0	50.8	69.8	95.3	91.9	6.4	8	28.4	171.5	15.0
2.1/2"	266.7	74.7	57.2	79.4	114.3	104.6	6.4	8	31.8	196.9	21.7
3"	304.8	90.7	66.5	92.1	133.4	127.0	6.4	8	35.1	228.6	32.8
4"	355.6	116.1	76.2	107.9	165.1	157.2	6.4	8	41.1	273.1	50.4
5"	419.1	143.8	91.9	130.2	203.2	185.7	6.4	8	47.8	323.9	83.7
6"	482.6	170.7	108.0	152.4	235.0	215.9	6.4	8	53.8	368.3	129.4
8"	552.5	221.5	127.0	177.8	304.8	269.7	6.4	12	53.8	438.2	190.0
10"	673.1	276.3	165.1	228.6	374.4	323.9	6.4	12	66.5	539.8	359.0
12"	762.0	327.1	184.2	254.0	441.5	381.0	6.4	12	73.2	619.3	509.3

Forged Stainless Steel Flanges - ANSI

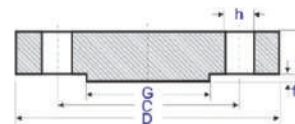

ANSI /ASTM STANDARD - 150# BLRF

BLIND FLANGE (RAISED FACE)

Nominal Pipe Size	Outside Dia. (mm)	Thickness Min. (mm)	Dia. of Raised Face (mm)	Height of Raised Face (mm)	Number of Bolt Holes	Dia. of Bolt Holes (mm)	Dia. of Bolt Circle (mm)	Approx. Weight (KG)
	D	t	G	f		h	C	
1/2"	88.9	11.2	35.1	1.6	4	15.7	60.5	0.5
3/4"	98.6	12.7	42.9	1.6	4	15.7	69.9	0.7
1"	108.0	14.2	50.8	1.6	4	15.7	79.2	0.9
1.1/4"	117.3	15.7	63.5	1.6	4	15.7	88.9	1.2
1.1/2"	127.0	17.5	73.2	1.6	4	15.7	98.6	1.6
2"	152.4	19.1	91.9	1.6	4	19.1	120.7	2.5
2.1/2"	177.8	22.4	104.6	1.6	4	19.1	139.7	4.0
3"	190.5	23.9	127.0	1.6	4	19.1	152.4	4.9
3.1/2"	215.9	23.9	139.7	1.6	8	19.1	177.8	6.2
4"	228.6	23.9	157.2	1.6	8	19.1	190.5	7.0
5"	254.0	23.9	185.7	1.6	8	22.4	215.9	8.7
6"	279.4	25.4	215.9	1.6	8	22.4	241.3	11.3
8"	342.9	28.4	269.7	1.6	8	22.4	298.5	20.0
10"	406.4	30.2	323.9	1.6	12	25.4	362.0	29.0
12"	482.6	31.8	381.0	1.6	12	25.4	431.8	44.0
14"	533.4	35.1	412.8	1.6	12	28.4	476.2	59.0
16"	596.9	36.6	469.9	1.6	16	28.4	539.7	76.0
18"	635.0	39.6	533.4	1.6	16	31.8	577.8	94.0
20"	698.5	42.9	584.2	1.6	20	31.8	635.0	122.0
22"	749.3	46.0	641.2	1.6	20	35.1	692.1	161.0
24"	812.8	47.8	692.2	1.6	20	35.1	749.3	185.0

BLIND FLANGE

ANSI /ASTM STANDARD - 300# BLRF

BLIND FLANGE (RAISED FACE)

Nominal Pipe Size	Outside Dia. (mm)	Thickness Min. (mm)	Dia. of Raised Face (mm)	Height of Raised Face (mm)	Number of Bolt Holes	Dia. of Bolt Holes (mm)	Dia. of Bolt Circle (mm)	Approx. Weight (KG)
	D	t	G	f		h	C	
1/2"	95.2	14.2	35.0	1.6	4	15.7	66.7	0.7
3/4"	117.3	15.7	42.9	1.6	4	19.0	82.5	1.2
1"	123.9	17.5	50.8	1.6	4	19.0	88.9	1.4
1.1/4"	133.3	19.0	63.5	1.6	4	19.0	98.4	1.8
1.1/2"	155.4	20.6	73.1	1.6	4	22.3	114.3	2.7
2"	165.1	22.3	91.9	1.6	8	19.0	127.0	3.2
2.1/2"	190.5	25.4	104.6	1.6	8	22.3	149.2	4.9
3"	209.5	28.4	127.0	1.6	8	22.3	168.3	7.0
3.1/2"	228.6	30.2	139.7	1.6	8	22.3	184.1	9.0
4"	254.0	31.7	157.2	1.6	8	22.3	200.0	12.0
5"	279.4	35.0	185.6	1.6	8	22.3	234.9	16.0
6"	317.5	36.5	215.9	1.6	12	22.3	269.9	21.0
8"	381.0	41.1	269.7	1.6	12	25.4	330.2	35.0
10"	444.5	47.7	323.8	1.6	16	28.4	387.3	54.0
12"	520.7	50.8	381	1.6	16	31.7	450.8	87.9
14"	584.2	53.8	412.7	1.6	20	31.7	514.3	105.0
16"	647.7	57.1	469.9	1.6	20	35.0	571.5	137.0
18"	711.2	60.4	533.4	1.6	24	35.0	628.6	175.0
20"	774.7	63.5	584.2	1.6	24	35.0	685.8	221.0
22"	838.2	66.7	641.2	1.6	24	41.1	742.9	290.0
24"	914.4	69.8	692.1	1.6	24	41.1	812.8	340.0

Forged Stainless Steel Flanges – ANSI

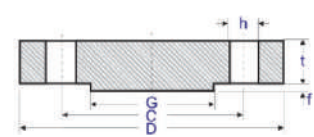

ANSI /ASTM STANDARD – 600# BLRF

BLIND FLANGE (RAISED FACE)

Nominal Pipe Size	Outside Dia. (mm)	Thickness Min. (mm)	Dia. of Raised Face (mm)	Height of Raised Face (mm)	Number of Bolt Holes	Dia. of Bolt Holes (mm)	Dia. of Bolt Circle (mm)	Approx. Weight (KG)
	D	t	G	f		h	C	
1/2"	95.3	14.2	35.1	6.4	4	15.7	66.5	0.8
3/4"	117.3	15.7	42.9	6.4	4	19.1	82.6	1.3
1"	124.0	17.5	50.8	6.4	4	19.1	88.9	1.6
1.1/4"	133.4	20.6	63.5	6.4	4	19.1	98.6	2.3
1.1/2"	155.4	22.4	73.2	6.4	4	22.4	114.3	3.3
2"	165.1	25.4	91.9	6.4	8	19.1	127.0	4.2
2.1/2"	190.5	28.4	104.6	6.4	8	22.4	149.4	6.2
3"	209.6	31.8	127.0	6.4	8	22.4	168.1	8.5
3.1/2"	228.6	35.1	139.7	6.4	8	25.4	184.2	11.0
4"	273.1	38.1	157.2	6.4	8	25.4	215.9	18.0
5"	330.2	44.5	185.7	6.4	8	28.4	266.7	30.0
6"	355.6	47.8	215.9	6.4	12	28.4	292.1	36.0
8"	419.1	55.6	269.7	6.4	12	31.8	349.3	65.9
10"	508.0	63.5	323.9	6.4	16	35.1	431.8	98.0
12"	558.8	66.5	381.0	6.4	20	35.1	489.0	124.0
14"	603.3	69.9	412.8	6.4	20	38.1	527.1	151.0
16"	685.8	76.2	469.9	6.4	20	41.1	603.3	214.0
18"	743.0	82.6	533.4	6.4	20	44.5	654.1	272.0
20"	812.8	88.9	584.2	6.4	24	44.5	723.9	349.0
22"	869.9	95.2	641.2	6.4	24	47.6	777.9	454.0
24"	939.8	101.6	692.2	6.4	24	50.8	838.2	533.0

ANSI /ASTM STANDARD – 900# BLRF

BLIND FLANGE (RAISED FACE)

Nominal Pipe Size	Outside Dia. (mm)	Thickness Min. (mm)	Dia. of Raised Face (mm)	Height of Raised Face (mm)	Number of Bolt Holes	Dia. of Bolt Holes (mm)	Dia. of Bolt Circle (mm)	Approx. Weight (KG)
	D	t	G	f		h	C	
1/2"	120.6	22.3	35.0	6.4	4	22.3	82.5	1.8
3/4"	130.1	25.4	42.9	6.4	4	22.3	88.9	2.5
1"	149.3	28.4	50.8	6.4	4	25.4	101.6	3.6
1.1/4"	158.7	28.4	63.5	6.4	4	25.4	111.2	4.2
1.1/2"	177.8	31.7	73.1	6.4	4	28.4	123.9	5.8
2"	215.9	38.1	91.9	6.4	8	25.4	165.1	11.0
2.1/2"	244.3	41.1	104.6	6.4	8	28.4	190.5	14.0
3"	241.3	38.1	127.0	6.4	8	25.4	190.5	13.1
4"	292.1	44.4	157.2	6.4	8	31.7	234.9	27.0
5"	349.2	50.8	185.6	6.4	8	35.0	279.4	36.5
6"	381.0	55.6	215.9	6.4	12	31.7	317.5	48.0
8"	469.9	63.5	269.7	6.4	12	38.1	393.7	83.0
10"	546.1	69.8	323.8	6.4	16	38.1	469.9	122.0
12"	609.6	79.2	381.0	6.4	20	38.1	533.4	173.0
14"	641.3	85.8	412.7	6.4	20	41.1	558.8	206.0
16"	704.8	88.9	469.9	6.4	20	44.4	615.9	259.0
18"	787.4	101.6	533.4	6.4	20	50.8	685.8	367.0
20"	857.2	107.9	584.2	6.4	20	53.8	749.3	463.0
24"	1041.4	139.7	692.1	6.4	20	66.5	901.7	876.0

BLIND FLANGE

Forged Stainless Steel Flanges - ANSI

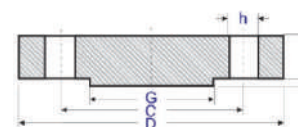

ANSI /ASTM STANDARD - 1500# BLRF

BLIND FLANGE (RAISED FACE)

Nominal Pipe Size	Outside Dia. (mm)	Thickness Min. (mm)	Dia. of Raised Face (mm)	Height of Raised Face (mm)	Number of Bolt Holes	Dia. of Bolt Holes (mm)	Dia. of Bolt Circle (mm)	Approx. Weight (KG)
	D	t	G	f		h	C	
1/2"	120.6	22.3	35.0	6.4	4	22.3	82.5	1.8
3/4"	130.1	25.4	42.9	6.4	4	22.3	88.9	2.5
1"	149.3	28.4	50.8	6.4	4	25.4	101.6	3.6
1.1/4"	158.7	28.4	63.5	6.4	4	25.4	111.1	4.2
1.1/2"	177.8	31.7	73.1	6.4	4	28.4	123.8	5.8
2"	215.9	38.1	91.9	6.4	8	25.4	165.1	11.0
2.1/2"	244.3	41.1	104.6	6.4	8	28.4	190.5	14.0
3"	266.7	47.7	127.0	6.4	8	31.7	203.2	20.0
4"	311.1	53.8	157.2	6.4	8	35.0	241.3	30.0
5"	374.6	73.1	185.6	6.4	8	41.1	292.1	59.0
6"	393.7	82.5	215.9	6.4	12	38.1	317.5	72.0
8"	482.6	91.9	269.7	6.4	12	44.4	393.7	122.0
10"	584.2	107.9	323.8	6.4	12	50.8	482.6	210.0
12"	673.1	123.9	381.0	6.4	16	53.8	571.5	316.0
14"	749.3	133.3	412.7	6.4	16	60.4	635.0	420.0
16"	825.5	146.0	469.9	6.4	16	66.5	704.8	560.0
18"	914.4	162.0	533.4	6.4	16	73.1	774.7	760.0
20"	984.2	177.8	584.2	6.4	16	79.2	831.8	965.0
24"	1168.4	203.2	692.1	6.4	16	91.9	990.6	1558.0

BLIND FLANGE

ANSI /ASTM STANDARD - 2500# BLRF

BLIND FLANGE (RAISED FACE)

Nominal Pipe Size	Outside Dia. (mm)	Thickness Min. (mm)	Dia. of Raised Face (mm)	Height of Raised Face (mm)	Number of Bolt Holes	Dia. of Bolt Holes (mm)	Dia. of Bolt Circle (mm)	Approx. Weight (KG)
	D	t	G	f		h	C	
1/2"	133.4	30.2	35.1	6.4	4	22.4	88.9	3.0
3/4"	139.7	31.8	42.9	6.4	4	22.4	95.3	3.5
1"	158.8	35.1	50.8	6.4	4	25.4	108.0	5.0
1.1/4"	184.2	38.1	63.5	6.4	4	28.4	130.0	7.4
1.1/2"	203.2	44.5	73.2	6.4	4	31.8	146.1	10.5
2"	235.0	50.8	91.9	6.4	8	28.4	171.5	15.8
2.1/2"	266.7	57.2	104.6	6.4	8	31.8	196.9	23.0
3"	304.8	66.5	127.0	6.4	8	35.1	228.6	35.0
4"	355.6	76.2	157.2	6.4	8	41.1	273.1	54.6
5"	419.1	91.9	185.7	6.4	8	47.8	323.9	91.5
6"	482.6	108.0	215.9	6.4	8	53.8	368.3	143.0
8"	552.5	127.0	269.7	6.4	12	53.8	438.2	217.0
10"	673.1	165.1	323.9	6.4	12	66.5	539.8	415.6
12"	762.0	184.1	381.0	6.4	12	73.2	619.3	598.0

Forged Stainless Steel Flanges – ANSI

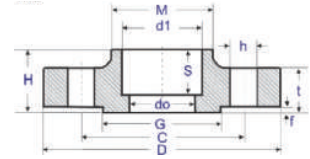

ANSI /ASTM STANDARD – 150# SWRF SOCKET WELD FLANGE (RAISED FACE)

Nominal Pipe Size	Dia. of Bore (mm)		Outside Dia. (mm)	Bore of Socket (mm)	Depth of Socket (mm)	Thickness Min. (mm)	Length Thru. Hub (mm)	Dia. at Base of Hub (mm)	Dia. of Raised Face (mm)	Height of Raised Face (mm)	Number of Bolt Holes	Dia. of Bolt Holes (mm)	Dia. of Bolt Circle (mm)	Approx. Weight (KG)
	Sch 40S/STD	Sch 80S/XS												
	do		D	d1	S	t	H	M	G	f		h	C	
1/2"	15.8	13.9	88.9	22.4	9.6	11.2	15.7	30.2	35.1	1.6	4	15.7	60.5	0.5
3/4"	20.9	18.8	98.6	27.7	11.1	12.7	15.7	38.1	42.9	1.6	4	15.7	69.9	0.6
1"	26.6	24.3	108.0	34.5	12.7	14.2	17.5	49.2	50.8	1.6	4	15.7	79.2	0.9
1.1/4"	35.1	32.5	117.3	43.2	14.2	15.7	20.6	58.7	63.5	1.6	4	15.7	88.9	1.1
1.1/2"	40.9	38.1	127.0	49.5	15.7	17.5	22.4	65.0	73.1	1.6	4	15.7	98.6	1.4
2"	52.5	49.3	152.4	62.0	17.5	19.1	25.4	77.7	91.9	1.6	4	19.1	120.7	2.1
2.1/2"	62.7	59.0	177.8	74.7	19.0	22.4	28.4	90.4	104.6	1.6	4	19.1	139.7	3.4
3"	77.9	73.7	190.5	90.7	20.6	23.9	30.2	108.0	127.0	1.6	4	19.1	152.4	3.9
3.1/2"	90.1	85.5	215.9	103.4	22.2	23.9	31.7	122.2	139.7	1.6	8	19.1	177.8	5.0
4"	102.3	97.2	228.6	116.1	23.8	23.9	33.3	134.9	157.2	1.6	8	19.1	190.5	5.9
5"	128.0	122.3	254.0	143.8	23.8	23.9	36.5	163.5	185.7	1.6	8	22.2	215.9	6.8
6"	154.1	146.3	279.4	170.7	27.0	25.4	39.7	192.1	215.9	1.6	8	22.2	241.3	8.6
8"	202.7	193.7	342.9	221.5	31.7	28.6	44.4	246.1	269.9	1.6	8	22.4	298.4	13.7
10"	254.4	247.7	406.4	276.3	33.3	30.2	49.2	304.8	323.8	1.6	12	25.4	361.9	19.6
12"	304.9	298.5	482.6	327.1	39.7	31.8	55.6	365.1	381.0	1.6	12	25.4	431.8	29.0
14"	336.6	330.2	533.4	359.1	41.3	34.9	57.1	400.0	412.7	1.6	12	28.6	476.2	41.0
16"	387.3	381.6	596.9	410.5	44.4	36.5	63.5	457.2	469.9	1.6	16	28.6	539.7	44.5
18"	438.1	431.8	635.0	461.8	49.2	39.7	68.3	504.8	533.4	1.6	16	31.7	577.8	59.0
20"	488.9	482.6	698.5	513.1	54.0	42.9	73.0	558.8	584.2	1.6	20	31.7	635.0	75.0
24"	590.5	584.2	812.8	615.9	63.5	47.6	82.5	663.6	692.1	1.6	20	34.9	749.3	99.0

SOCKET WELDING FLANGE

ANSI /ASTM STANDARD – 300# SWRF SOCKET WELD FLANGE (RAISED FACE)

Nominal Pipe Size	Dia. of Bore (mm)		Outside Dia. (mm)	Bore of Socket (mm)	Depth of Socket (mm)	Thickness Min. (mm)	Length Thru. Hub (mm)	Dia. at Base of Hub (mm)	Dia. of Raised Face (mm)	Height of Raised Face (mm)	Number of Bolt Holes	Dia. of Bolt Holes (mm)	Dia. of Bolt Circle (mm)	Approx. Weight (KG)
	Sch 40S/STD	Sch 80S/XS												
	do		D	d1	S	t	H	M	G	f		h	C	
1/2"	15.8	13.9	95.2	22.4	9.6	14.2	22.3	38.1	35.1	1.6	4	15.7	66.5	0.9
3/4"	20.9	18.8	117.3	27.7	11.1	15.7	25.4	47.7	42.9	1.6	4	19.1	82.5	1.2
1"	26.6	24.3	123.9	34.5	12.7	17.5	26.9	53.8	50.8	1.6	4	19.1	88.9	1.4
1.1/4"	35.1	32.5	133.3	43.2	14.2	19.0	26.9	63.5	63.5	1.6	4	19.1	98.5	1.8
1.1/2"	40.9	38.1	155.4	49.5	15.7	20.6	30.2	69.8	73.1	1.6	4	22.3	114.3	2.6
2"	52.5	49.3	165.1	62.0	17.5	22.3	33.2	84.0	91.9	1.6	8	19.1	127.0	3.0
2.1/2"	62.7	59.0	190.5	74.7	19.0	25.4	38.1	100.0	104.6	1.6	8	22.3	149.3	4.4
3"	77.9	73.7	209.5	90.7	20.6	28.4	42.9	117.3	127.0	1.6	8	22.3	168.1	6.0
3.1/2"	90.1	85.5	228.6	103.4	22.3	30.2	44.4	133.3	139.7	1.6	8	22.3	184.1	7.7
4"	102.3	97.2	254.0	116.1	23.8	31.8	47.6	146.0	157.2	1.6	8	22.3	200.0	10.0

Forged Stainless Steel Flanges – ANSI

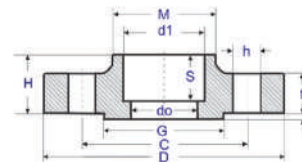

ANSI /ASTM STANDARD – 600# SWRF

SOCKET WELD FLANGE (RAISED FACE)

Nominal Pipe Size	Dia. of Bore (mm)		Outside Dia. (mm)	Bore of Socket (mm)	Depth of Socket (mm)	Thickness Min. (mm)	Length Thru. Hub (mm)	Dia. at Base of Hub (mm)	Dia. of Raised Face (mm)	Height of Raised Face (mm)	Number of Bolt Holes	Dia. of Bolt Holes (mm)	Dia. of Bolt Circle (mm)	Approx. Weight (KG)
	Sch 40S/STD	Sch 80S/XS												
	do		D	d1	S	t	H	M	G	f		h	C	
1/2"	15.8	13.9	95.3	22.4	9.6	14.2	22.4	38.1	35.1	6.4	4	15.7	66.5	0.9
3/4"	20.9	18.8	117.3	27.7	11.1	15.7	25.4	47.8	42.9	6.4	4	19.1	82.6	1.3
1"	26.6	24.3	124.0	34.5	12.7	17.5	26.9	53.8	50.8	6.4	4	19.1	88.9	1.6
1.1/4"	35.1	32.5	133.4	43.2	14.2	20.6	28.4	63.5	63.5	6.4	4	19.1	98.6	2.1
1.1/2"	40.9	38.1	155.4	49.5	15.7	22.4	31.8	69.9	73.1	6.4	4	22.4	114.3	3.0
2"	52.5	49.3	165.1	62.0	17.5	25.4	36.6	84.1	91.9	6.4	8	19.1	127.0	3.7
2.1/2"	62.7	59.0	190.5	74.7	19.0	28.4	41.1	100.0	104.6	6.4	8	22.4	149.4	5.4
3"	77.9	73.7	209.6	90.7	20.6	31.8	46.0	117.3	127.0	6.4	8	22.4	168.1	7.1

SOCKET WELDING FLANGE

ANSI /ASTM STANDARD – 1500# SWRF

SOCKET WELD FLANGE (RAISED FACE)

Nominal Pipe Size	Dia. of Bore (mm)		Outside Dia. (mm)	Bore of Socket (mm)	Depth of Socket (mm)	Thickness Min. (mm)	Length Thru. Hub (mm)	Dia. at Base of Hub (mm)	Dia. of Raised Face (mm)	Height of Raised Face (mm)	Number of Bolt Holes	Dia. of Bolt Holes (mm)	Dia. of Bolt Circle (mm)	Approx. Weight (KG)
	Sch 40S/STD	Sch 80S/XS												
	do		D	d1	S	t	H	M	G	f		h	C	
1/2"	15.8	13.9	120.6	22.4	9.6	22.3	31.7	38.1	35.1	6.4	4	22.3	82.5	1.8
3/4"	20.9	18.8	130.0	27.7	11.1	25.4	35.0	44.4	42.9	6.4	4	22.3	88.9	2.4
1"	26.6	24.3	149.3	34.5	12.7	28.4	41.1	52.3	50.8	6.4	4	25.4	101.6	3.5
1.1/4"	35.1	32.5	158.7	43.2	14.2	28.4	41.1	63.5	63.5	6.4	4	25.4	111.2	4.0
1.1/2"	40.9	38.1	177.8	49.5	15.7	31.7	44.5	69.8	73.1	6.4	4	28.4	123.9	5.4
2"	52.5	49.3	215.9	62.0	17.5	38.1	57.1	104.6	91.9	6.4	8	25.4	165.1	10.2
2.1/2"	62.7	59.0	244.3	74.7	19.0	41.1	63.5	123.9	104.6	6.4	8	28.4	190.5	13.9

Forged Carbon Steel Flanges – ANSI

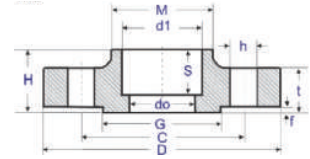

ANSI /ASTM STANDARD – 150# SWRF SOCKET WELD FLANGE (RAISED FACE)

Nominal Pipe Size	Dia. of Bore (mm)		Outside Dia. (mm)	Bore of Socket (mm)	Depth of Socket (mm)	Thickness Min. (mm)	Length Thru. Hub (mm)	Dia. at Base of Hub (mm)	Dia. of Raised Face (mm)	Height of Raised Face (mm)	Number of Bolt Holes	Dia. of Bolt Holes (mm)	Dia. of Bolt Circle (mm)	Approx. Weight (KG)
	Sch 40	Sch 80												
	do		D	d1	S	t	H	M	G	f		h	C	
1/2"	15.8	13.9	88.9	22.4	9.6	11.2	15.7	30.2	35.1	1.6	4	15.7	60.5	0.4
3/4"	20.9	18.8	98.6	27.7	11.1	12.7	15.7	38.1	42.9	1.6	4	15.7	69.9	0.6
1"	26.6	24.3	108.0	34.5	12.7	14.2	17.5	49.2	50.8	1.6	4	15.7	79.2	0.8
1.1/4"	35.1	32.5	117.3	43.2	14.2	15.7	20.6	58.7	63.5	1.6	4	15.7	88.9	1.1
1.1/2"	40.9	38.1	127.0	49.5	15.7	17.5	22.4	65.0	73.1	1.6	4	15.7	98.6	1.4
2"	52.5	49.3	152.4	62.0	17.5	19.1	25.4	77.7	91.9	1.6	4	19.1	120.7	2.2
2.1/2"	62.7	59.0	177.8	74.7	19.0	22.4	28.4	90.4	104.6	1.6	4	19.1	139.7	3.5
3"	77.9	73.7	190.5	90.7	20.6	23.9	30.2	108.0	127.0	1.6	4	19.1	152.4	4.0
3.1/2"	90.1	85.5	215.9	103.4	22.2	23.9	31.7	122.2	139.7	1.6	8	19.1	177.8	5.2
4"	102.3	97.2	228.6	116.1	23.8	23.9	33.3	134.9	157.2	1.6	8	19.1	190.5	5.7
5"	128.0	122.3	254.0	143.8	23.8	23.9	36.5	163.5	185.7	1.6	8	22.2	215.9	7.0
6"	154.1	146.3	279.4	170.7	27.0	25.4	39.7	192.1	215.9	1.6	8	22.2	241.3	8.7
8"	202.7	193.7	342.9	221.5	31.7	28.6	44.4	246.1	269.9	1.6	8	22.4	298.5	14.4
10"	254.4	242.8	406.4	276.3	33.3	30.2	49.2	304.8	323.8	1.6	12	25.4	362.0	20.5
12"	303.2	288.8	482.6	327.1	39.7	31.8	55.6	365.1	381.0	1.6	12	25.4	431.8	31.3
14"	333.4	317.6	533.4	359.1	41.3	34.9	57.1	400.0	412.7	1.6	12	28.6	476.2	39.4
16"	381.0	363.6	596.9	410.5	44.4	36.5	63.5	457.2	469.9	1.6	16	28.6	539.7	53.4
18"	428.6	409.6	635.0	461.8	49.2	39.7	68.3	504.8	533.4	1.6	16	31.7	577.8	59.0
20"	477.8	455.6	698.5	513.1	54.0	42.9	73.0	558.8	584.2	1.6	20	31.7	635.0	73.9
24"	574.6	547.6	812.8	615.9	63.5	47.6	82.5	663.6	692.1	1.6	20	34.9	749.3	108.2

SOCKET WELDING FLANGE

ANSI /ASTM STANDARD – 300# SWRF SOCKET WELD FLANGE (RAISED FACE)

Nominal Pipe Size	Dia. of Bore (mm)		Outside Dia. (mm)	Bore of Socket (mm)	Depth of Socket (mm)	Thickness Min. (mm)	Length Thru. Hub (mm)	Dia. at Base of Hub (mm)	Dia. of Raised Face (mm)	Height of Raised Face (mm)	Number of Bolt Holes	Dia. of Bolt Holes (mm)	Dia. of Bolt Circle (mm)	Approx. Weight (KG)
	Sch 40	Sch 80												
	do		D	d1	S	t	H	M	G	f		h	C	
1/2"	15.8	13.9	95.2	22.4	9.6	14.2	22.3	38.1	35.1	1.6	4	15.7	66.5	0.7
3/4"	20.9	18.8	117.3	27.7	11.1	15.7	25.4	47.7	42.9	1.6	4	19.1	82.5	1.2
1"	26.6	24.3	123.9	34.5	12.7	17.5	26.9	53.8	50.8	1.6	4	19.1	88.9	1.4
1.1/4"	35.1	32.5	133.3	43.2	14.2	19.0	26.9	63.5	63.5	1.6	4	19.1	98.5	1.8
1.1/2"	40.9	38.1	155.4	49.5	15.7	20.6	30.2	69.8	73.1	1.6	4	22.3	114.3	2.6
2"	52.5	49.3	165.1	62.0	17.5	22.3	33.2	84.0	91.9	1.6	8	19.1	127.0	3.0
2.1/2"	62.7	59.0	190.5	74.7	19.0	25.4	38.1	100.0	104.6	1.6	8	22.3	149.3	4.6
3"	77.9	73.7	209.5	90.7	20.6	28.4	42.9	117.3	127.0	1.6	8	22.3	168.1	6.3
3.1/2"	90.1	85.5	228.6	103.4	22.2	30.2	44.4	133.3	139.7	1.6	8	22.3	184.1	7.9
4"	102.3	97.2	254.0	116.1	23.8	31.8	47.6	146.0	157.2	1.6	8	22.3	200.0	10.3

Forged Carbon Steel Flanges – ANSI

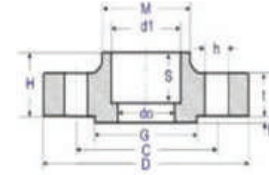

ANSI /ASTM STANDARD – 600# SWRF

SOCKET WELD FLANGE (RAISED FACE)

Nominal Pipe Size	Dia. of Bore (mm)		Outside Dia. (mm)	Bore of Socket (mm)	Depth of Socket (mm)	Thickness Min. (mm)	Length Thru. Hub (mm)	Dia. at Base of Hub (mm)	Dia. of Raised Face (mm)	Height of Raised Face (mm)	Number of Bolt Holes	Dia. of Bolt Holes (mm)	Dia. of Bolt Circle (mm)	Approx. Weight (KG)
	Sch 40	Sch 80												
	do		D	d1	S	t	H	M	G	f		h	C	
1/2"	15.8	13.9	95.3	22.4	9.6	14.2	22.4	38.1	35.1	6.4	4	15.7	66.5	0.8
3/4"	20.9	18.8	117.3	27.7	11.1	15.7	25.4	47.8	42.9	6.4	4	19.1	82.5	1.3
1"	26.6	24.3	124.0	34.5	12.7	17.5	26.9	53.8	50.8	6.4	4	19.1	88.9	1.6
1.1/4"	35.1	32.5	133.4	43.2	14.2	20.6	28.4	63.5	63.5	6.4	4	19.1	98.6	2.2
1.1/2"	40.9	38.1	155.4	49.5	15.7	22.4	31.8	69.9	73.1	6.4	4	22.4	114.3	3.2
2"	52.5	49.3	165.1	62.0	17.5	25.4	36.6	84.1	91.9	6.4	8	19.1	127.0	3.9
2.1/2"	62.7	59.0	190.5	74.7	19.0	28.4	41.1	100.0	104.6	6.4	8	22.4	149.4	5.9
3"	77.9	73.7	209.6	90.7	20.6	31.8	46.0	117.3	127.0	6.4	8	22.4	168.1	7.7

SOCKET WELDING FLANGE

ANSI /ASTM STANDARD – 1500# SWRF

SOCKET WELD FLANGE (RAISED FACE)

Nominal Pipe Size	Dia. of Bore (mm)		Outside Dia. (mm)	Bore of Socket (mm)	Depth of Socket (mm)	Thickness Min. (mm)	Length Thru. Hub (mm)	Dia. at Base of Hub (mm)	Dia. of Raised Face (mm)	Height of Raised Face (mm)	Number of Bolt Holes	Dia. of Bolt Holes (mm)	Dia. of Bolt Circle (mm)	Approx. Weight (KG)
	Sch 40	Sch 80												
	do		D	d1	S	t	H	M	G	f		h	C	
1/2"	15.8	13.9	120.6	22.4	9.6	22.3	31.7	38.1	35.1	6.4	4	22.3	82.5	1.9
3/4"	20.9	18.8	130.0	27.7	11.1	25.4	35.0	44.4	42.9	6.4	4	22.3	88.9	2.9
1"	26.6	24.3	149.3	34.5	12.7	28.4	41.1	52.3	50.8	6.4	4	25.4	101.6	3.9
1.1/4"	35.1	32.5	158.7	43.2	14.2	28.4	41.1	63.5	63.5	6.4	4	25.4	111.2	4.4
1.1/2"	40.9	38.1	177.8	49.5	15.7	31.7	44.5	69.8	73.1	6.4	4	28.4	123.9	6.1
2"	52.5	49.3	215.9	62.0	17.5	38.1	57.1	104.6	91.9	6.4	8	25.4	166.1	10.8
2.1/2"	62.7	59.0	244.3	74.7	19.0	41.1	63.5	123.9	104.6	6.4	8	28.4	190.5	15.2

Forged Stainless Steel Flanges – ANSI

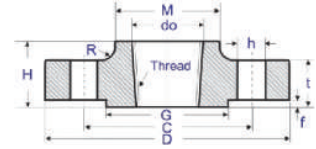

ANSI /ASTM STANDARD – 150# THRF THREADED FLANGE (RAISED FACE)

Nominal Pipe Size	Outside Dia. (mm)	Dia. of Bore (mm)	Thickness Min. (mm)	Length Thru. Hub (mm)	Thread Length (mm)	Dia. at Base of Hub (mm)	Dia. of Raised Face (mm)	Height of Raised Face (mm)	Number of Bolt Holes	Dia. of Bolt Holes (mm)	Dia. of Bolt Circle (mm)	Approx. Weight (KG)
	D	do	t	H	T	M	G	f		h	C	
1/2"	88.9		11.2	15.7	16.0	30.2	35.1	1.6	4	15.7	60.5	0.4
3/4"	98.6		12.7	15.7	16.0	38.1	42.9	1.6	4	15.7	69.9	0.6
1"	108.0		14.2	17.5	17.0	49.3	50.8	1.6	4	15.7	79.2	0.8
1.1/4"	117.3		15.7	20.6	21.0	58.7	63.5	1.6	4	15.7	88.9	1.1
1.1/2"	127.0		17.5	22.4	22.0	65.0	73.2	1.6	4	15.7	98.6	1.4
2"	152.4		19.1	25.4	25.0	77.7	91.9	1.6	4	19.1	120.7	2.1
2.1/2"	177.8		22.4	28.4	29.0	90.4	104.6	1.6	4	19.1	139.7	3.3
3"	190.5	to be	23.9	30.2	30.0	108.0	127.0	1.6	4	19.1	152.4	3.9
3.1/2"	215.9	specified	23.9	31.8	32.0	122.2	139.7	1.6	8	19.1	177.8	4.8
4"	228.6	by end	23.9	33.3	33.0	134.9	157.2	1.6	8	19.1	190.5	5.3
5"	254.0	user	23.9	36.6	36.0	163.6	185.7	1.6	8	22.4	215.9	6.1
6"	279.4		25.4	39.6	40.0	192.0	215.9	1.6	8	22.4	241.3	7.6
8"	342.9		28.4	44.5	44.0	246.1	269.7	1.6	8	22.4	298.5	12.1
10"	406.4		30.2	49.3	49.0	304.8	323.9	1.6	12	25.4	362.0	16.5
12"	482.6		31.8	55.6	56.0	365.3	381.0	1.6	12	25.4	431.8	27.0
14"	533.4		35.1	57.2	79.0	400.1	412.8	1.6	12	28.4	476.3	35.0
16"	596.9		36.6	63.5	87.0	457.2	469.9	1.6	16	28.4	539.8	45.0
18"	635.0		39.6	68.3	97.0	505.0	533.4	1.6	16	31.8	577.9	49.0
20"	698.5		42.9	73.2	103.0	558.8	584.2	1.6	20	31.8	635.0	62.0
24"	812.8		47.8	82.6	111.0	663.4	692.1	1.6	20	35.1	749.3	87.0

THREADED FLANGE

ANSI /ASTM STANDARD – 300# THRF THREADED FLANGE (RAISED FACE)

Nominal Pipe Size	Outside Dia. (mm)	Dia. of Bore (mm)	Thickness Min. (mm)	Length Thru. Hub (mm)	Thread Length (mm)	Dia. at Base of Hub (mm)	Dia. of Raised Face (mm)	Height of Raised Face (mm)	Number of Bolt Holes	Dia. of Bolt Holes (mm)	Dia. of Bolt Circle (mm)	Approx. Weight (KG)
	D	do	t	H	T	M	G	f		h	C	
1/2"	95.2	23.6	14.2	22.3	15.7	38.1	35.0	1.6	4	15.7	66.5	0.7
3/4"	117.3	29.0	15.7	25.4	15.7	47.7	42.9	1.6	4	19.0	82.5	1.2
1"	123.9	35.8	17.5	26.9	17.5	53.8	50.8	1.6	4	19.0	88.9	1.4
1.1/4"	133.3	44.4	19.0	26.9	20.5	63.5	63.5	1.6	4	19.0	98.5	1.7
1.1/2"	155.4	50.5	20.6	30.2	22.3	69.8	73.1	1.6	4	22.3	114.3	2.5
2"	165.1	63.5	22.3	33.2	28.4	84.0	91.9	1.6	8	19.0	127.0	2.9
2.1/2"	190.5	76.2	25.4	38.1	31.7	100.0	104.6	1.6	8	22.3	149.3	4.4
3"	209.5	92.2	28.4	42.9	31.7	117.3	127.0	1.6	8	22.3	168.1	5.9
3.1/2"	228.6	104.9	30.2	44.4	36.5	133.3	139.7	1.6	8	22.3	184.1	7.4
4"	254.0	117.6	31.7	47.7	36.5	146.0	157.2	1.6	8	22.3	200.1	10.0
5"	279.4	144.5	35.0	50.8	42.9	177.8	185.6	1.6	8	22.3	234.9	12.3
6"	317.5	171.4	36.5	52.3	45.9	206.2	215.9	1.6	12	22.3	269.7	15.6
8"	381.0	222.2	41.1	61.9	50.8	260.3	269.7	1.6	12	25.4	330.2	24.2
10"	444.5	276.3	47.7	66.5	55.6	320.5	323.8	1.6	16	28.4	387.3	34.1
12"	520.7	328.7	50.8	73.1	60.4	374.6	381.0	1.6	16	31.7	450.8	50.0
14"	584.2	360.4	53.8	76.2	63.5	425.4	412.7	1.6	20	31.7	514.3	70.0
16"	647.7	411.2	57.1	82.5	68.3	482.6	469.9	1.6	20	35.0	571.5	89.0
18"	711.2	462.0	60.4	88.9	69.8	533.4	533.4	1.6	24	35.0	628.6	109.0
20"	774.7	512.8	63.5	95.2	73.1	587.2	584.2	1.6	24	35.0	685.8	134.0
24"	914.4	614.4	69.8	106.4	82.5	701.5	692.1	1.6	24	41.1	812.8	201.0

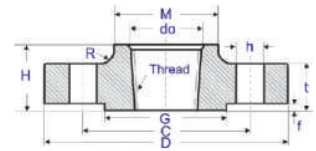

Forged Stainless Steel Flanges – ANSI

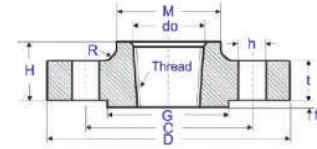

ANSI /ASTM STANDARD – 600# THRF THREADED FLANGE (RAISED FACE)

Nominal Pipe Size	Outside Dia. (mm)	Dia. of Bore (mm)	Thickness Min. (mm)	Length Thru. Hub (mm)	Thread Length (mm)	Dia. at Base of Hub (mm)	Dia. of Raised Face (mm)	Height of Raised Face (mm)	Number of Bolt Holes	Dia. of Bolt Holes (mm)	Dia. of Bolt Circle (mm)	Approx. Weight (KG)
	D	do	t	H	T	M	G	f		h	C	
1/2"	95.3	23.6	14.2	22.4	15.7	38.1	35.1	6.4	4	15.7	66.5	0.8
3/4"	117.3	29.0	15.7	25.4	15.7	47.8	42.9	6.4	4	19.1	82.6	1.3
1"	124.0	35.8	17.5	26.9	17.5	53.8	50.8	6.4	4	19.1	88.9	1.6
1.1/4"	133.4	44.4	20.6	28.4	20.6	63.5	63.5	6.4	4	19.1	98.6	2.1
1.1/2"	155.4	50.5	22.4	31.8	22.4	69.9	73.1	6.4	4	22.4	114.3	3.0
2"	165.1	63.5	25.4	36.6	28.4	84.1	91.9	6.4	8	19.1	127.0	3.7
2.1/2"	190.5	76.2	28.4	41.1	31.8	100.1	104.6	6.4	8	22.4	149.4	5.3
3"	209.6	92.2	31.8	46.0	35.1	117.3	127.0	6.4	8	22.4	168.1	7.0
3.1/2"	228.6	104.9	35.1	49.3	39.6	133.4	139.7	6.4	8	25.4	184.2	8.9
4"	273.1	117.6	38.1	53.8	41.1	152.4	157.2	6.4	8	25.4	215.9	15.0
5"	330.2	144.5	44.5	60.5	47.8	189.0	185.7	6.4	8	28.4	266.7	25.0
6"	355.6	171.5	47.8	66.5	50.8	222.3	215.9	6.4	12	28.4	292.1	29.0
8"	419.1	222.3	55.6	76.2	57.2	273.1	269.7	6.4	12	31.8	349.3	44.0
10"	508.0	276.4	63.5	85.9	65.0	342.9	323.9	6.4	16	35.1	431.8	71.0
12"	558.8	328.7	66.5	91.9	69.9	400.1	381.0	6.4	20	35.1	489.0	85.0
14"	603.3	360.4	69.9	93.7	73.2	431.8	412.8	6.4	20	38.1	527.1	99.0
16"	685.8	411.2	76.2	106.4	77.7	495.3	469.9	6.4	20	41.1	603.3	142.0
18"	743.0	462.0	82.6	117.3	79.2	546.1	533.4	6.4	20	44.5	654.1	173.0
20"	812.8	512.8	88.9	127.0	82.6	609.6	584.2	6.4	24	44.5	723.9	220.0
24"	939.8	614.4	101.6	139.7	91.9	717.6	692.1	6.4	24	50.8	838.2	312.0

THREADED FLANGE

ANSI /ASTM STANDARD – 900# THRF THREADED FLANGE (RAISED FACE)

Nominal Pipe Size	Outside Dia. (mm)	Dia. of Bore (mm)	Thickness Min. (mm)	Length Thru. Hub (mm)	Thread Length (mm)	Dia. at Base of Hub (mm)	Dia. of Raised Face (mm)	Height of Raised Face (mm)	Number of Bolt Holes	Dia. of Bolt Holes (mm)	Dia. of Bolt Circle (mm)	Approx. Weight (KG)
	D	do	t	H	T	M	G	f		h	C	
1/2"	120.6	23.6	22.3	31.7	22.3	38.1	34.9	6.4	4	22.3	82.5	1.8
3/4"	130.0	29.0	25.4	35.0	25.4	44.4	42.9	6.4	4	22.3	88.9	2.3
1"	149.3	35.8	28.4	41.1	28.4	52.3	50.8	6.4	4	25.4	101.6	3.6
1.1/4"	158.7	44.4	28.4	41.1	30.2	63.5	63.5	6.4	4	25.4	111.2	4.1
1.1/2"	177.8	50.5	31.7	44.5	31.8	69.8	73.1	6.4	4	28.4	123.9	5.4
2"	215.9	63.5	38.1	57.1	38.1	104.6	91.9	6.4	8	25.4	165.1	10.0
2.1/2"	244.3	76.2	41.1	63.5	47.7	123.9	104.6	6.4	8	28.4	190.5	14.0
3"	241.3	92.2	38.1	53.8	41.1	127.0	127.0	6.4	8	25.4	190.5	12.0
4"	292.1	117.6	44.4	69.8	47.8	158.7	157.2	6.4	8	31.7	234.9	20.0
5"	349.2	144.5	50.8	79.2	53.8	190.5	185.6	6.4	8	35.0	279.4	32.0
6"	381.0	171.4	55.6	85.8	57.1	234.9	215.9	6.4	12	31.7	317.5	42.0
8"	469.9	222.2	63.5	101.6	63.5	298.4	269.7	6.4	12	38.1	393.7	71.0
10"	546.1	276.3	69.8	107.9	71.4	368.3	323.8	6.4	16	38.1	469.9	101.0
12"	609.6	328.7	79.4	117.3	76.2	419.1	381.0	6.4	20	38.1	533.4	133.0
14"	641.3	360.4	85.7	130.0	82.5	450.8	412.7	6.4	20	41.3	558.8	153.0
16"	704.8	411.2	88.9	133.3	85.9	508.0	469.9	6.4	20	44.4	618.9	185.0
18"	787.4	462.0	101.6	152.4	88.9	565.1	533.4	6.4	20	50.8	685.8	258.0
20"	857.2	512.8	107.9	158.7	91.9	622.3	584.2	6.4	20	54.0	749.3	317.0
24"	1041.4	614.4	139.7	203.2	101.6	749.3	692.1	6.4	20	66.5	901.7	606.0

Forged Stainless Steel Flanges – ANSI

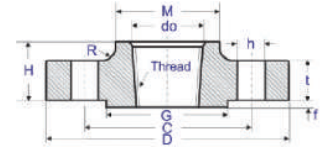

ANSI /ASTM STANDARD – 1500# THRF THREADED FLANGE (RAISED FACE)

Nominal Pipe Size	Outside Dia. (mm)	Dia. of Bore (mm)	Thickness Min. (mm)	Length Thru. Hub (mm)	Thread Length (mm)	Dia. at Base of Hub (mm)	Dia. of Raised Face (mm)	Height of Raised Face (mm)	Number of Bolt Holes	Dia. of Bolt Holes (mm)	Dia. of Bolt Circle (mm)	Approx. Weight (KG)
	D	do	t	H	T	M	G	f		h	C	
1/2"	120.6	23.6	22.3	31.7	22.3	38.1	35.0	6.4	4	22.3	82.5	1.8
3/4"	130.0	29.0	25.4	35.0	25.4	44.4	42.9	6.4	4	22.3	88.9	2.3
1"	149.3	35.8	28.4	41.1	28.4	52.3	50.8	6.4	4	25.4	101.6	3.6
1.1/4"	158.7	44.4	28.4	41.1	30.2	63.5	63.5	6.4	4	25.4	111.2	4.0
1.1/2"	177.8	50.5	31.7	44.5	31.7	69.8	73.1	6.4	4	28.4	123.9	5.4
2"	215.9	63.5	38.1	57.1	38.1	104.6	91.9	6.4	8	25.4	165.1	10.0
2.1/2"	244.3	76.2	41.1	63.5	47.7	123.9	104.6	6.4	8	28.4	190.5	14.0
3"	266.7	92.2	47.7	73.1	50.8	133.3	127.0	6.4	8	31.7	203.2	18.0
4"	311.1	117.6	53.8	90.4	57.1	162.0	157.2	6.4	8	35.1	241.3	40.0
5"	374.6	144.5	73.1	104.6	63.5	196.8	185.6	6.4	8	41.1	292.1	52.0
6"	393.7	171.4	82.5	119.1	69.8	228.6	215.9	6.4	12	38.1	317.5	61.0
8"	482.6	222.2	91.9	142.7	76.2	292.1	269.7	6.4	12	44.4	393.7	103.0
10"	584.2	276.3	107.9	158.7	84.0	368.3	323.8	6.4	12	50.8	482.6	175.0
12"	673.1	328.7	123.9	180.8	91.9	450.8	381.0	6.4	16	53.8	571.5	264.0

THREADED FLANGE

ANSI /ASTM STANDARD – 2500# THRF THREADED FLANGE (RAISED FACE)

Nominal Pipe Size	Outside Dia. (mm)	Dia. of Bore (mm)	Thickness Min. (mm)	Length Thru. Hub (mm)	Thread Length (mm)	Dia. at Base of Hub (mm)	Dia. of Raised Face (mm)	Height of Raised Face (mm)	Number of Bolt Holes	Dia. of Bolt Holes (mm)	Dia. of Bolt Circle (mm)	Approx. Weight (KG)
	D	do	t	H	T	M	G	f		h	C	
1/2"	133.4	23.6	30.2	39.6	28.4	42.9	35.1	6.4	4	22.4	88.9	3.0
3/4"	139.7	29.0	31.8	42.9	31.8	50.8	42.9	6.4	4	22.4	95.3	3.5
1"	158.8	35.8	35.1	47.8	35.1	57.2	50.8	6.4	4	25.4	108.0	4.9
1.1/4"	184.2	44.5	38.1	52.3	38.1	73.2	63.5	6.4	4	28.4	130.0	7.2
1.1/2"	203.2	50.5	44.5	60.5	44.5	79.2	73.2	6.4	4	31.8	146.1	10.0
2"	235.0	63.5	50.8	69.9	50.8	95.3	91.9	6.4	8	28.4	171.5	15.0
2.1/2"	266.7	76.2	57.2	79.2	57.2	114.3	104.6	6.4	8	31.8	196.9	22.0
3"	304.8	92.2	66.5	91.9	63.5	133.4	127.0	6.4	8	35.1	228.6	33.0
4"	355.6	117.6	76.2	108.0	69.9	165.1	157.2	6.4	8	41.1	273.1	53.0
5"	419.1	144.5	91.9	130.0	76.2	203.2	185.7	6.4	8	47.8	323.9	84.0
6"	482.6	171.5	108.0	152.4	82.6	235.0	215.9	6.4	8	53.8	368.3	128.0
8"	552.5	222.3	127.0	177.8	95.3	304.8	269.7	6.4	12	53.8	438.2	188.0
10"	673.1	276.4	165.1	228.6	108.0	374.7	323.9	6.4	12	66.5	539.8	355.0
12"	762.0	328.7	184.2	254.0	120.7	441.5	381.0	6.4	12	73.2	619.3	504.0

Forged Stainless Steel Flanges – ANSI

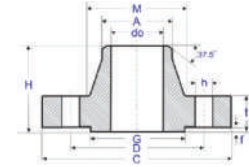

ANSI /ASTM STANDARD – 150# WNRF WELDING NECK FLANGE (RAISED FACE)

Nominal Pipe Size	Dia. of Bore (mm)			Outside Dia. (mm)	Thickness Min. (mm)	Length Thru. Hub (mm)	Outside Dia. of Neck (mm)	Dia. at Base of Hub (mm)	Dia. of Raised Face (mm)	Height of Raised Face (mm)	Number of Bolt Holes	Dia. of Bolt Holes (mm)	Dia. of Bolt Circle (mm)	Approx. Weight (kg)
	Sch 10S	Sch 40S/STD	Sch 80S/XS											
	do			C	t	H	A	M	G	f		h	D	
1/2"	17.1	15.8	13.9	88.9	11.2	47.8	21.3	30.2	35.1	1.6	4	15.7	60.5	0.5
3/4"	22.5	20.9	18.8	98.6	12.7	52.3	26.7	38.1	42.9	1.6	4	15.7	69.9	0.7
1"	27.9	26.6	24.5	108.0	14.2	55.6	33.5	49.3	50.8	1.6	4	15.7	79.2	1.0
1.1/4"	36.6	35.1	32.5	117.3	15.7	57.2	42.2	58.7	63.5	1.6	4	15.7	88.9	1.4
1.1/2"	42.7	40.9	38.1	127.0	17.5	62.0	48.3	65.0	73.2	1.6	4	15.7	98.6	1.8
2"	54.9	52.7	49.5	152.4	19.1	63.5	60.5	77.7	91.9	1.6	4	19.1	120.7	2.6
2.1/2"	67.2	62.7	59.0	177.8	22.4	69.9	73.2	90.4	104.6	1.6	4	19.1	139.7	4.2
3"	82.9	77.9	73.7	190.5	23.9	69.9	88.9	108.0	127.0	1.6	4	19.1	152.4	5.0
3.1/2"	95.6	90.1	85.5	215.9	23.9	71.4	101.6	122.2	139.7	1.6	8	19.1	177.8	6.1
4"	108.3	102.3	97.2	228.6	23.9	76.2	114.3	134.9	157.2	1.6	8	19.1	190.5	7.0
5"	134.4	128.2	122.3	254.0	23.9	88.9	141.2	163.6	185.7	1.6	8	22.4	215.9	8.6
6"	161.6	154.2	146.3	279.4	25.4	88.9	168.4	192.0	215.9	1.6	8	22.4	241.3	10.6
8"	211.6	202.7	193.7	342.9	28.4	101.6	219.2	246.1	269.7	1.6	8	22.4	298.5	17.6
10"	264.6	254.5	247.7	406.4	30.2	101.6	273.1	304.8	323.8	1.6	12	25.4	362.0	24.0
12"	314.6	304.9	298.5	482.6	31.8	114.3	323.9	365.3	381.0	1.6	12	25.4	431.8	37.0
14"	346.0	336.6	330.2	533.4	35.1	127.0	355.6	400.1	412.8	1.6	12	28.4	476.3	49.0
16"	396.8	387.3	381.0	596.9	36.6	127.0	406.4	457.2	469.9	1.6	16	28.4	539.8	61.0
18"	447.6	438.1	431.8	635.0	39.6	139.7	457.2	505.0	533.4	1.6	16	31.8	577.9	68.0
20"	497.0	488.9	482.6	698.5	42.9	144.5	508.0	558.8	584.2	1.6	20	31.8	635.0	85.0
22"	547.7	539.7	533.4	749.3	46.0	149.2	558.8	609.6	641.2	1.6	20	35.1	692.1	102.0
24"	598.5	590.5	584.2	812.8	47.8	152.4	609.6	663.4	692.2	1.6	20	35.1	749.3	115.0

ANSI /ASTM STANDARD – 300# WNRF WELDING NECK FLANGE (RAISED FACE)

Nominal Pipe Size	Dia. of Bore (mm)			Outside Dia. (mm)	Thickness Min. (mm)	Length Thru. Hub (mm)	Outside Dia. of Neck (mm)	Dia. at Base of Hub (mm)	Dia. of Raised Face (mm)	Height of Raised Face (mm)	Number of Bolt Holes	Dia. of Bolt Holes (mm)	Dia. of Bolt Circle (mm)	Approx. Weight (kg)
	Sch 10S	Sch 40S/STD	Sch 80S/XS											
	do			C	t	H	A	M	G	f		h	D	
1/2"	17.1	15.8	13.9	95.2	14.3	51.0	21.3	38.0	35.0	1.6	4	15.7	66.5	0.8
3/4"	22.5	20.9	18.8	117.3	15.9	56.0	26.7	48.0	42.9	1.6	4	19.0	82.5	1.3
1"	27.9	26.6	24.5	123.9	17.5	60.0	33.4	54.0	50.8	1.6	4	19.0	88.9	1.6
1.1/4"	36.6	35.1	32.5	133.3	19.1	64.0	42.2	64.0	63.5	1.6	4	19.0	98.5	2.1
1.1/2"	42.7	40.9	38.1	155.4	20.7	67.0	48.3	70.0	73.1	1.6	4	22.3	114.3	3.0
2"	54.9	52.7	49.5	165.1	22.3	68.0	60.3	84.0	91.9	1.6	8	19.0	127.0	3.4
2.1/2"	67.2	62.7	59.0	190.5	25.4	75.0	73.0	100.0	104.6	1.6	8	22.3	149.3	5.2
3"	82.9	77.9	73.7	209.5	28.6	78.0	88.9	117.0	127.0	1.6	8	22.3	168.1	7.0
3.1/2"	95.6	90.1	85.5	228.6	30.2	79.0	101.6	133.0	139.7	1.6	8	22.3	184.1	8.7
4"	108.3	102.3	97.2	254.0	31.8	84.0	114.3	146.0	157.2	1.6	8	22.3	200.1	11.2
5"	134.4	128.2	122.3	279.4	35.0	97.0	141.3	178.0	185.6	1.6	8	22.3	234.9	16.0
6"	161.6	154.2	146.3	317.5	36.6	97.0	168.3	206.0	215.9	1.6	12	22.3	269.7	20.0
8"	211.6	202.7	193.7	381.0	41.3	110.0	219.1	260.0	269.7	1.6	12	25.4	330.2	30.0
10"	264.6	254.5	247.7	444.5	47.7	116.0	273.0	321.0	323.8	1.6	16	28.6	387.3	43.0
12"	314.6	304.9	298.5	520.0	50.8	129.0	323.8	375.0	381.0	1.6	16	31.7	450.8	62.0
14"	346.0	336.6	330.2	585.0	54.0	141.0	355.6	425.0	412.7	1.6	20	31.7	514.3	86.0
16"	396.8	387.3	381.0	650.0	57.2	144.0	406.4	483.0	469.9	1.6	20	35.0	571.5	106.0
18"	447.6	438.1	431.8	710.0	60.4	157.0	457.0	533.0	533.4	1.6	24	35.0	628.6	131.0
20"	497.0	488.9	482.6	775.0	63.5	160.0	508.0	587.0	584.2	1.6	24	35.0	685.8	158.0
22"	547.7	539.7	533.4	838.2	66.7	165.1	558.8	641.2	641.2	1.6	24	41.1	742.9	195.0
24"	598.5	590.5	584.2	915.0	69.9	167.0	610.0	702.0	692.1	1.6	24	41.1	812.8	230.0

WELDING NECK FLANGE

Forged Stainless Steel Flanges – ANSI

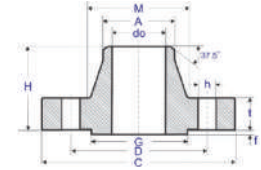

ANSI /ASTM STANDARD – 600# WNRF

WELDING NECK FLANGE (RAISED FACE)

Nominal Pipe Size	Dia. of Bore (mm)			Outside Dia. (mm)	Thickness Min. (mm)	Length Thru. Hub (mm)	Outside Dia. of Neck (mm)	Dia. at Base of Hub (mm)	Dia. of Raised Face (mm)	Height of Raised Face (mm)	Number of Bolt Holes	Dia. of Bolt Holes (mm)	Dia. of Bolt Circle (mm)	Approx. Weight (KG)
	Sch 10S	Sch 40S/STD	Sch 80S/XS											
	do			C	t	H	A	M	G	f		h	D	
1/2"	17.1	15.8	13.9	95.3	14.2	52.3	21.3	38.1	34.9	6.4	4	15.7	66.5	0.9
3/4"	22.5	20.9	18.8	117.3	15.7	57.2	26.7	47.8	42.9	6.4	4	19.1	82.6	1.5
1"	27.9	26.6	24.5	124.0	17.5	62.0	33.5	53.8	50.8	6.4	4	19.1	88.9	1.8
1.1/4"	36.6	35.1	32.5	133.4	20.6	66.5	42.2	63.5	63.5	6.4	4	19.1	98.6	2.5
1.1/2"	42.7	40.9	38.1	155.4	22.4	69.9	48.3	69.9	73.0	6.4	4	22.4	114.3	3.5
2"	54.9	52.7	49.5	165.1	25.4	73.2	60.5	84.1	92.1	6.4	8	19.1	127.0	4.4
2.1/2"	67.2	62.7	59.0	190.5	28.4	79.2	73.2	100.1	104.8	6.4	8	22.4	149.4	6.4
3"	82.9	77.9	73.7	209.6	31.8	82.6	88.9	117.3	127.0	6.4	8	22.4	168.1	8.6
3.1/2"	95.6	90.1	85.5	228.6	35.1	85.9	101.6	133.4	139.7	6.4	8	25.4	184.2	11.7
4"	108.3	102.3	97.2	273.1	38.1	101.6	114.3	152.4	157.2	6.4	8	25.4	215.9	18.0
5"	134.4	128.2	122.3	330.2	44.5	114.3	141.2	189.0	185.7	6.4	8	28.4	266.7	30.0
6"	161.6	154.2	146.3	355.6	47.8	117.3	168.4	222.3	215.9	6.4	12	28.4	292.1	35.0
8"	211.6	202.7	193.7	419.1	55.6	133.4	219.2	273.1	269.9	6.4	12	31.8	349.3	54.0
10"	264.6	254.5	247.7	508.0	63.5	152.4	273.1	342.9	323.8	6.4	16	35.1	431.8	87.0
12"	314.6	304.9	298.5	558.8	66.5	155.4	323.9	400.1	381.0	6.4	20	35.1	489.0	103.0
14"	346.0	336.6	330.2	603.3	69.9	165.1	355.6	431.8	412.8	6.4	20	38.1	527.1	122.0
16"	396.8	387.3	381.0	685.8	76.2	177.8	406.4	495.3	469.9	6.4	20	41.1	603.3	170.0
18"	447.6	438.1	431.8	743.0	82.6	184.2	457.2	546.1	533.4	6.4	20	44.5	654.1	204.0
20"	497.0	488.9	482.6	812.8	88.9	190.5	508.0	609.6	584.2	6.4	24	44.5	723.9	254.0
22"	547.7	539.7	533.4	869.9	95.2	196.8	558.8	666.7	641.2	6.4	24	47.6	777.9	281.0
24"	598.5	590.5	584.2	939.8	101.6	203.2	609.6	717.6	692.2	6.4	24	50.8	838.2	358.0

ANSI /ASTM STANDARD – 900# WNRF

WELDING NECK FLANGE (RAISED FACE)

Nominal Pipe Size	Dia. of Bore (mm)			Outside Dia. (mm)	Thickness Min. (mm)	Length Thru. Hub (mm)	Outside Dia. of Neck (mm)	Dia. at Base of Hub (mm)	Dia. of Raised Face (mm)	Height of Raised Face (mm)	Number of Bolt Holes	Dia. of Bolt Holes (mm)	Dia. of Bolt Circle (mm)	Approx. Weight (KG)
	Sch 10S	Sch 40S/STD	Sch 80S/XS											
	do			C	t	H	A	M	G	f		h	D	
1/2"	17.1	15.8	13.9	120.6	22.3	60.4	21.3	38.1	35.0	6.4	4	22.3	82.5	2.3
3/4"	22.5	20.9	18.8	130.2	25.4	69.8	26.7	44.4	42.9	6.4	4	22.3	88.9	2.7
1"	27.9	26.6	24.5	149.3	28.4	73.1	33.4	52.3	50.8	6.4	4	25.4	101.6	4.1
1.1/4"	36.6	35.1	32.5	158.7	28.4	73.1	42.2	63.5	63.5	6.4	4	25.4	111.2	4.5
1.1/2"	42.7	40.9	38.1	177.8	31.7	82.5	48.3	69.8	73.1	6.4	4	28.4	123.9	5.9
2"	54.9	52.7	49.5	215.9	38.1	101.6	60.3	104.6	91.9	6.4	8	25.4	165.1	11.3
2.1/2"	67.2	62.7	59.0	244.3	41.1	104.6	73.0	123.9	104.6	6.4	8	28.4	190.5	16.3
3"	82.9	77.9	73.7	241.3	38.1	101.6	88.9	127.0	127.0	6.4	8	25.4	190.5	14.0
4"	108.3	102.3	97.2	292.1	44.4	114.3	114.3	158.7	157.2	6.4	8	31.7	234.9	23.0
5"	134.4	128.2	122.3	349.2	50.8	127.0	141.2	190.5	185.6	6.4	8	35.0	279.4	38.0
6"	161.6	154.2	146.3	381.0	55.6	139.7	168.4	234.9	215.9	6.4	12	31.7	317.5	48.0
8"	211.6	202.7	193.7	469.9	63.5	162.0	219.2	298.4	269.7	6.4	12	38.1	393.7	82.0
10"	264.6	254.5	247.7	546.1	69.8	184.1	273.0	368.3	323.8	6.4	16	38.1	469.9	119.0
12"	314.6	304.9	298.5	609.6	79.2	200.1	323.8	419.1	381.0	6.4	20	38.1	533.4	157.0
14"	346.0	336.6	330.2	641.3	85.8	212.8	355.6	450.8	412.7	6.4	20	41.1	558.8	180.0
16"	396.8	387.3	381.0	704.8	88.9	215.9	406.4	508.0	469.9	6.4	20	44.4	615.9	217.0
18"	447.6	438.1	431.8	787.4	101.6	228.6	457.2	565.1	533.4	6.4	20	50.8	685.8	298.0
20"	497.0	488.9	482.6	857.2	107.9	247.6	508.0	622.3	584.2	6.4	20	53.8	749.3	362.0
24"	598.5	590.5	584.2	1041.4	139.7	292.1	609.6	749.3	692.1	6.4	20	66.5	901.7	665.0

WELDING NECK FLANGE

Forged Stainless Steel Flanges – ANSI

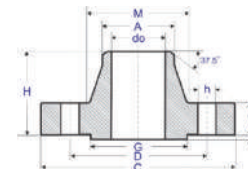

ANSI /ASTM STANDARD – 1500# WNRF

WELDING NECK FLANGE (RAISED FACE)

Nominal Pipe Size	Dia. of Bore (mm)			Outside Dia. (mm)	Thickness Min. (mm)	Length Thru. Hub (mm)	Outside Dia. of Neck (mm)	Dia. at Base of Hub (mm)	Dia. of Raised Face (mm)	Height of Raised Face (mm)	Number of Bolt Holes	Dia. of Bolt Holes (mm)	Dia. of Bolt Circle (mm)	Approx. Weight (kg)
	Sch 10S	Sch 40S/STD	Sch 80S/XS											
	do			C	t	H	A	M	G	f		h	D	
1/2"	17.1	15.8	13.9	120.6	22.3	60.4	21.3	38.1	35.0	6.4	4	22.3	82.5	2.3
3/4"	22.5	20.9	18.8	130.2	25.4	69.8	26.7	44.4	42.9	6.4	4	22.3	88.9	2.7
1"	27.9	26.6	24.5	149.3	28.4	73.1	33.4	52.3	50.8	6.4	4	25.4	101.6	4.1
1.1/4"	36.6	35.1	32.5	158.7	28.4	73.1	42.2	63.5	63.5	6.4	4	25.4	111.2	4.5
1.1/2"	42.7	40.9	38.1	177.8	31.7	82.5	48.3	69.8	73.1	6.4	4	28.4	123.9	5.9
2"	54.9	52.7	49.5	215.9	38.1	101.6	60.3	104.6	91.9	6.4	8	25.4	165.1	11.3
2.1/2"	67.2	62.7	59.0	244.3	41.1	104.6	73.0	123.9	104.6	6.4	8	28.4	190.5	16.3
3"	82.9	77.9	73.7	266.7	47.7	117.3	88.9	133.3	127.0	6.4	8	31.7	203.2	21.8
4"	108.3	102.3	97.2	311.1	53.8	123.9	114.3	162.0	157.2	6.4	8	35.0	241.3	33.0
5"	134.4	128.2	122.3	374.6	73.1	155.4	141.2	196.8	185.6	6.4	8	41.1	292.1	59.0
6"	161.6	154.2	146.3	393.7	82.5	171.4	168.4	228.6	215.9	6.4	12	38.1	317.5	75.0
8"	211.6	202.7	193.7	482.6	91.9	212.8	219.2	292.1	269.7	6.4	12	44.4	393.7	125.0
10"	264.6	254.5	247.7	584.2	107.9	254.0	273.0	368.3	323.8	6.4	12	50.8	482.6	206.0
12"	314.6	304.9	298.5	673.1	123.9	282.4	323.8	450.8	381.0	6.4	16	53.8	571.5	313.0
14"	346.0	336.6	330.2	749.3	133.3	298.4	355.6	495.3	412.7	6.4	16	60.4	635.0	380.0
16"	396.8	387.3	381.0	825.5	146.0	311.1	406.4	552.4	469.9	6.4	16	66.5	704.8	485.0
18"	447.6	438.1	431.8	914.4	162.0	327.1	457.2	596.9	533.4	6.4	16	73.1	774.7	644.0
20"	497.0	488.9	482.6	984.2	177.8	355.6	508.0	641.3	584.2	6.4	16	79.2	831.8	775.0
24"	598.5	590.5	584.2	1168.4	203.2	406.4	609.6	762.0	692.1	6.4	16	91.9	990.6	1232.0

ANSI /ASTM STANDARD – 2500# WNRF

WELDING NECK FLANGE (RAISED FACE)

Nominal Pipe Size	Dia. of Bore (mm)			Outside Dia. (mm)	Thickness Min. (mm)	Length Thru. Hub (mm)	Outside Dia. of Neck (mm)	Dia. at Base of Hub (mm)	Dia. of Raised Face (mm)	Height of Raised Face (mm)	Number of Bolt Holes	Dia. of Bolt Holes (mm)	Dia. of Bolt Circle (mm)	Approx. Weight (kg)
	Sch 10S	Sch 40S/STD	Sch 80S/XS											
	do			C	t	H	A	M	G	f		h	D	
1/2"	17.1	15.8	13.9	133.4	30.2	73.2	21.3	42.9	35.1	6.4	4	22.4	88.9	3.2
3/4"	22.5	20.9	18.8	139.7	31.8	79.2	26.7	50.8	42.9	6.4	4	22.4	95.3	3.7
1"	27.9	26.6	24.5	158.8	35.1	88.9	33.5	57.2	50.8	6.4	4	25.4	108.0	5.3
1.1/4"	36.6	35.1	32.5	184.2	38.1	95.3	42.2	73.2	63.5	6.4	4	28.4	130.0	7.8
1.1/2"	42.7	40.9	38.1	203.2	44.5	111.3	48.3	79.2	73.2	6.4	4	31.8	146.1	11.0
2"	54.9	52.7	49.5	235.0	50.8	127.0	60.5	95.3	91.9	6.4	8	28.4	171.5	17.0
2.1/2"	67.2	62.7	59.0	266.7	57.2	142.7	73.2	114.3	104.6	6.4	8	31.8	196.9	24.0
3"	82.9	77.9	73.7	304.8	66.5	168.1	88.9	133.4	127.0	6.4	8	35.1	228.6	37.0
4"	108.3	102.3	97.2	355.6	76.2	190.5	114.3	165.1	157.2	6.4	8	41.1	273.1	56.0
5"	134.4	128.2	122.3	419.1	91.9	228.6	141.2	203.2	185.7	6.4	8	47.8	323.9	93.0
6"	161.6	154.2	146.3	482.6	108.0	273.1	168.4	235.0	215.9	6.4	8	53.8	368.3	143.0
8"	211.6	202.7	193.7	552.5	127.0	317.5	219.2	304.8	269.7	6.4	12	53.8	438.2	215.0
10"	264.6	254.5	247.7	673.1	165.1	419.1	273.0	374.7	323.9	6.4	12	66.5	539.8	406.0
12"	314.6	304.9	298.5	762.0	184.2	463.6	323.9	441.5	381.0	6.4	12	73.2	619.3	572.0

WELDING NECK FLANGE

Forged Carbon Steel Flanges – ANSI

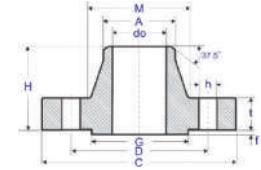

ANSI /ASTM STANDARD – 150# WNRF WELDING NECK FLANGE (RAISED FACE)

Nominal Pipe Size	Dia. of Bore (mm)			Outside Dia. (mm)	Thickness Min. (mm)	Length Thru. Hub (mm)	Outside Dia. of Neck (mm)	Dia. at Base of Neck (mm)	Dia. of Raised Face (mm)	Height of Raised Face (mm)	Number of Bolt Holes	Dia. of Bolt Holes (mm)	Dia. of Bolt Circle (mm)	Approx. Weight (KG)
	Sch 40	Sch 80	Sch 160											
	do			C	t	H	A	M	G	f		h	D	
1/2"	15.8	13.9	11.7	88.9	11.2	47.8	21.3	30.2	35.1	1.6	4	15.7	60.5	0.5
3/4"	20.9	18.8	15.5	98.6	12.7	52.3	26.7	38.1	42.9	1.6	4	15.7	69.9	0.7
1"	26.6	24.5	20.7	108.0	14.2	55.6	33.5	49.3	50.8	1.6	4	15.7	79.2	1.1
1.1/4"	35.1	32.5	29.4	117.3	15.7	57.2	42.2	58.7	63.5	1.6	4	15.7	88.9	1.4
1.1/2"	40.9	38.1	34.1	127.0	17.5	62.0	48.3	65.0	73.2	1.6	4	15.7	98.6	1.8
2"	52.7	49.5	43.1	152.4	19.1	63.5	60.5	77.7	91.9	1.6	4	19.1	120.7	2.7
2.1/2"	62.7	59.0	54.2	177.8	22.4	69.9	73.2	90.4	104.6	1.6	4	19.1	139.7	4.3
3"	77.9	73.7	66.7	190.5	23.9	69.9	88.9	108.0	127.0	1.6	4	19.1	152.4	5.1
3.1/2"	90.1	85.5	-	215.9	23.9	71.4	101.6	122.2	139.7	1.6	8	19.1	177.8	5.9
4"	102.3	97.2	87.3	228.6	23.9	76.2	114.3	134.9	157.2	1.6	8	19.1	190.5	7.2
5"	128.2	122.3	109.4	254.0	23.9	88.9	141.2	163.6	185.7	1.6	8	22.4	215.9	9.0
6"	154.2	146.3	131.8	279.4	25.4	88.9	168.4	192.0	215.9	1.6	8	22.4	241.3	11.1
8"	202.7	193.7	173.2	342.9	28.4	101.6	219.2	246.1	269.7	1.6	8	22.4	298.5	18.4
10"	254.5	242.8	215.8	406.4	30.2	101.6	273.1	304.8	323.8	1.6	12	25.4	362.0	25.2
12"	303.2	288.8	257.2	482.6	31.8	114.3	323.9	365.3	381.0	1.6	12	25.4	431.8	39.3
14"	333.4	317.6	284.2	533.4	35.1	127.0	355.6	400.1	412.8	1.6	12	28.4	476.3	57.2
16"	381.0	363.6	325.4	596.9	36.6	127.0	406.4	457.2	469.9	1.6	16	28.4	539.8	67.1
18"	428.6	409.6	366.8	635.0	39.6	139.7	457.2	505.0	533.4	1.6	16	31.8	577.9	78.9
20"	477.8	455.6	408.0	698.5	42.9	144.5	508.0	558.8	584.2	1.6	20	31.8	635.0	98.2
24"	574.6	547.6	490.6	812.8	47.8	152.4	609.6	663.4	692.2	1.6	20	35.1	749.3	138.2

ANSI /ASTM STANDARD – 300# WNRF WELDING NECK FLANGE (RAISED FACE)

Nominal Pipe Size	Dia. of Bore (mm)			Outside Dia. (mm)	Thickness Min. (mm)	Length Thru. Hub (mm)	Outside Dia. of Neck (mm)	Dia. at Base of Neck (mm)	Dia. of Raised Face (mm)	Height of Raised Face (mm)	Number of Bolt Holes	Dia. of Bolt Holes (mm)	Dia. of Bolt Circle (mm)	Approx. Weight (KG)
	Sch 40	Sch 80	Sch 160											
	do			C	t	H	A	M	G	f		h	D	
1/2"	15.8	13.9	11.7	95.2	14.2	51.0	21.3	38.1	35.0	1.6	4	15.7	66.5	0.8
3/4"	20.9	18.8	15.5	117.3	15.7	56.0	26.7	47.7	42.9	1.6	4	19.1	82.5	1.3
1"	26.6	24.5	20.7	123.9	17.5	60.0	33.5	53.8	50.8	1.6	4	19.1	88.9	1.7
1.1/4"	35.1	32.5	29.4	133.3	19.0	64.0	42.2	63.5	63.5	1.6	4	19.1	98.5	2.1
1.1/2"	40.9	38.1	34.1	155.4	20.6	67.0	48.3	69.8	73.1	1.6	4	22.4	114.3	3.0
2"	52.7	49.5	43.1	165.1	22.3	68.0	60.4	84.0	91.9	1.6	8	19.1	127.0	3.6
2.1/2"	62.7	59.0	54.2	190.5	25.4	75.0	73.1	100.0	104.6	1.6	8	22.4	149.3	5.4
3"	77.9	73.7	66.7	209.5	28.4	78.0	88.9	117.3	127.0	1.6	8	22.4	168.1	7.2
3.1/2"	90.1	85.5	-	228.6	30.0	79.0	101.6	133.4	139.7	1.6	8	22.4	184.2	9.0
4"	102.3	97.2	87.3	254.0	31.8	97.0	114.3	146.0	157.2	1.6	8	22.4	200.1	11.7
5"	128.2	122.3	109.4	279.4	35.0	97.0	141.2	177.8	185.6	1.6	8	22.4	234.9	15.7
6"	154.2	146.3	131.8	317.5	36.5	110.0	168.4	206.2	215.9	1.6	12	22.4	269.7	20.0
8"	202.7	193.7	173.2	381.0	41.1	116.0	219.2	206.3	269.7	1.6	12	25.4	330.2	31.2
10"	254.5	242.8	215.8	444.5	47.7	129.0	273.0	320.5	323.8	1.6	16	28.6	387.3	44.9
12"	303.2	288.8	257.2	520.7	50.8	141.0	323.8	374.6	381.0	1.6	16	31.7	450.8	65.3
14"	333.4	317.6	284.2	584.2	53.8	144.0	355.6	425.4	412.7	1.6	20	31.7	514.3	91.9
16"	381.0	363.6	325.4	647.7	57.1	157.0	406.4	482.6	469.9	1.6	20	35.0	571.5	116.2
18"	428.6	409.6	366.8	711.2	60.4	160.0	527.2	533.4	533.4	1.6	24	35.0	628.6	145.9
20"	477.8	455.6	408.0	774.7	63.5	165.1	508.0	587.2	584.2	1.6	24	35.0	685.8	177.1
24"	574.6	547.6	490.6	914.4	69.8	167.0	609.6	701.5	692.1	1.6	24	41.1	812.8	260.4

WELDING NECK FLANGE

Forged Carbon Steel Flanges – ANSI

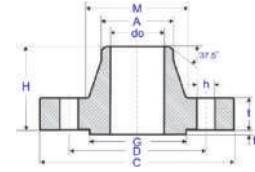

ANSI /ASTM STANDARD – 600# WNRF

WELDING NECK FLANGE (RAISED FACE)

Nominal Pipe Size	Dia. of Bore (mm)			Outside Dia. (mm)	Thickness Min. (mm)	Length Thru. Hub (mm)	Outside Dia. of Neck (mm)	Dia. at Base of Neck (mm)	Dia. of Raised Face (mm)	Height of Raised Face (mm)	Number of Bolt Holes	Dia. of Bolt Holes (mm)	Dia. of Bolt Circle (mm)	Approx. Weight (KG)
	Sch 40	Sch 80	Sch 160											
	do			C	t	H	A	M	G	f		h	D	
1/2"	15.8	13.9	11.7	95.3	14.2	52.3	21.3	38.1	34.9	6.4	4	15.7	66.5	0.9
3/4"	20.9	18.8	15.5	117.3	15.7	57.2	26.7	47.8	42.9	6.4	4	19.1	82.6	1.5
1"	26.6	24.5	20.7	124.0	17.5	62.0	33.5	53.8	50.8	6.4	4	19.1	88.9	1.8
1.1/4"	35.1	32.5	29.4	133.4	20.6	66.5	42.2	63.5	63.5	6.4	4	19.1	98.6	2.5
1.1/2"	40.9	38.1	34.1	155.4	22.4	69.9	48.3	69.9	73.0	6.4	4	22.4	114.3	3.5
2"	52.7	49.5	43.1	165.1	25.4	73.2	60.5	84.1	92.1	6.4	8	19.1	127.0	4.4
2.1/2"	62.7	59.0	54.2	190.5	28.4	79.2	73.2	100.1	104.8	6.4	8	22.4	149.4	6.4
3"	77.9	73.7	66.7	209.6	31.8	82.6	88.9	117.3	127.0	6.4	8	22.4	168.1	8.6
3.1/2"	90.1	85.5	-	228.6	35.1	85.9	101.6	133.4	139.7	6.4	8	25.4	184.2	10.8
4"	102.3	97.2	87.3	273.1	38.1	101.6	114.3	152.4	157.2	6.4	8	25.4	215.9	17.5
5"	128.2	122.3	109.4	330.2	44.5	114.3	141.2	189.0	185.7	6.4	8	28.4	266.7	29.3
6"	154.2	146.3	131.8	355.6	47.8	117.3	168.4	222.3	215.9	6.4	12	28.4	292.1	34.8
8"	202.7	193.7	173.2	419.1	55.6	133.4	219.2	273.1	269.9	6.4	12	31.8	349.3	53.1
10"	254.5	242.8	215.8	508.0	63.5	152.4	273.1	342.9	323.8	6.4	16	35.1	431.8	86.9
12"	303.2	288.8	257.2	558.8	66.5	155.4	323.9	400.1	381.0	6.4	20	35.1	489.0	104.9
14"	333.4	317.6	284.2	603.3	69.9	165.1	355.6	431.8	412.8	6.4	20	38.1	527.1	125.8
16"	381.0	363.6	325.4	685.8	76.2	177.8	406.4	495.3	469.9	6.4	20	41.1	603.3	178.4
18"	428.6	409.6	366.8	743.0	82.6	184.2	457.2	546.1	533.4	6.4	20	44.5	654.1	216.2
20"	477.8	455.6	408.0	812.8	88.9	190.5	508.0	609.6	584.2	6.4	24	44.5	723.9	270.8
24"	574.6	547.6	490.6	939.8	101.6	203.2	609.6	717.6	692.2	6.4	24	50.8	838.2	386.6

ANSI /ASTM STANDARD – 900# WNRF

WELDING NECK FLANGE (RAISED FACE)

Nominal Pipe Size	Dia. of Bore (mm)			Outside Dia. (mm)	Thickness Min. (mm)	Length Thru. Hub (mm)	Outside Dia. of Neck (mm)	Dia. at Base of Neck (mm)	Dia. of Raised Face (mm)	Height of Raised Face (mm)	Number of Bolt Holes	Dia. of Bolt Holes (mm)	Dia. of Bolt Circle (mm)	Approx. Weight (KG)
	Sch 40	Sch 80	Sch 160											
	do			C	t	H	A	M	G	f		h	D	
1/2"	15.8	13.9	11.7	120.6	22.3	60.4	21.3	38.1	35.0	6.4	4	22.3	82.5	2.0
3/4"	20.9	18.8	15.5	130.2	25.4	69.8	26.7	44.4	42.9	6.4	4	22.3	88.9	2.7
1"	26.6	24.5	20.7	149.3	28.4	73.1	33.4	52.3	50.8	6.4	4	25.4	101.6	3.9
1.1/4"	35.1	32.5	29.4	158.7	28.4	73.1	42.2	63.5	63.5	6.4	4	25.4	111.2	4.5
1.1/2"	40.9	38.1	34.1	177.8	31.7	82.5	48.3	69.8	73.1	6.4	4	28.4	123.9	6.2
2"	52.7	49.5	43.1	215.9	38.1	101.6	60.3	104.6	91.9	6.4	8	25.4	165.1	11.5
2.1/2"	62.7	59.0	54.2	244.3	41.1	104.6	73.0	123.9	104.6	6.4	8	28.4	190.5	15.8
3"	77.9	73.7	66.7	241.3	38.1	101.8	88.9	127.0	127.0	6.4	8	25.4	190.5	14.7
4"	102.3	97.2	87.3	292.1	44.4	114.3	114.3	158.7	157.2	6.4	8	31.7	234.9	23.4
5"	128.2	122.3	109.4	349.2	50.8	127.0	141.2	190.5	185.6	6.4	8	35.0	279.4	37.3
6"	154.2	146.3	131.8	381.0	55.6	139.7	168.4	234.9	215.9	6.4	12	31.7	317.5	48.5
8"	202.7	193.7	173.2	469.9	63.5	162.0	219.2	298.4	269.7	6.4	12	38.1	393.7	83.4
10"	254.5	242.8	215.8	546.1	69.8	184.1	273.0	368.3	323.8	6.4	16	38.1	469.9	121.6
12"	303.2	288.8	257.2	609.6	79.2	200.1	323.8	419.1	381.0	6.4	20	38.1	533.4	162.6
14"	333.4	317.6	284.2	641.3	85.8	212.8	355.6	450.8	412.7	6.4	20	41.1	558.8	187.9
16"	381.0	363.6	325.4	704.8	88.9	215.9	406.4	508.0	469.9	6.4	20	44.4	615.9	229.6
18"	428.6	409.6	366.8	787.4	101.6	228.6	457.2	565.1	533.4	6.4	20	50.8	685.8	316.5
20"	477.8	455.6	408.0	857.2	107.9	247.6	508.0	622.3	584.2	6.4	20	53.8	749.3	397.6
24"	574.6	547.6	490.6	1041.4	139.7	292.1	609.6	749.3	692.1	6.4	20	66.5	901.7	742.4

WELDING NECK FLANGE

Forged Carbon Steel Flanges – ANSI

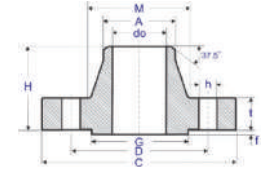

ANSI /ASTM STANDARD – 1500# WNRF

WELDING NECK FLANGE (RAISED FACE)

Nominal Pipe Size	Dia. of Bore (mm)			Outside Dia. (mm)	Thickness Min. (mm)	Length Thru. Hub (mm)	Outside Dia. of Neck (mm)	Dia. at Base of Neck (mm)	Dia. of Raised Face (mm)	Height of Raised Face (mm)	Number of Bolt Holes	Dia. of Bolt Holes (mm)	Dia. of Bolt Circle (mm)	Approx. Weight (KG)
	Sch 40	Sch 80	Sch 160											
	do			C	t	H	A	M	G	f		h	D	
1/2"	15.8	13.9	11.7	120.6	22.3	60.4	21.3	38.1	35.0	6.4	4	22.3	82.5	1.9
3/4"	20.9	18.8	15.5	130.2	25.4	69.8	26.7	44.4	42.9	6.4	4	22.3	88.9	2.6
1"	26.6	24.5	20.7	149.3	28.4	73.1	33.4	52.3	50.8	6.4	4	25.4	101.6	3.8
1.1/4"	35.1	32.5	29.4	158.7	28.4	73.1	42.2	63.5	63.5	6.4	4	25.4	111.2	4.3
1.1/2"	40.9	38.1	34.1	177.8	31.7	82.5	48.3	69.8	73.1	6.4	4	28.4	123.9	6.0
2"	52.7	49.5	43.1	215.9	38.1	101.6	60.3	104.6	91.9	6.4	8	25.4	165.1	11.0
2.1/2"	62.7	59.0	54.2	244.3	41.1	104.6	73.0	123.9	104.6	6.4	8	28.4	190.5	15.2
3"	77.9	73.7	66.7	266.7	47.7	117.3	88.9	133.3	127.0	6.4	8	31.7	203.2	20.8
4"	102.3	97.2	87.3	311.1	53.8	123.9	114.3	162.0	157.2	6.4	8	35.0	241.3	30.0
5"	128.2	122.3	109.4	374.6	73.1	155.4	141.2	196.8	185.6	6.4	8	41.1	292.1	57.2
6"	154.2	146.3	131.8	393.7	82.5	171.4	168.4	228.6	215.9	6.4	12	38.1	317.5	68.1
8"	202.7	193.7	173.2	482.6	91.9	212.8	219.2	292.1	269.7	6.4	12	44.4	393.7	857.3
10"	254.5	242.8	215.8	584.2	107.9	254.0	273.0	368.3	323.8	6.4	12	50.8	482.6	201.3
12"	303.2	288.8	257.2	673.1	123.9	282.4	323.8	450.8	381.0	6.4	16	53.8	571.5	302.5
14"	333.4	317.6	284.2	749.3	133.3	298.4	355.6	495.3	412.7	6.4	16	60.4	635.0	399.7
16"	381.0	363.6	325.4	825.5	146.0	311.1	406.4	552.4	469.9	6.4	16	66.5	704.8	513.5
18"	428.6	409.6	366.8	914.4	162.0	327.1	457.2	596.9	533.4	6.4	16	73.1	774.7	673.0
20"	477.8	455.6	408.0	984.2	177.8	355.6	508.0	641.3	584.2	6.4	16	79.2	831.8	826.3
24"	574.6	547.6	490.6	1168.4	203.2	406.4	609.6	762.0	692.1	6.4	16	91.9	990.6	1322.5

ANSI /ASTM STANDARD – 2500# WNRF

WELDING NECK FLANGE (RAISED FACE)

Nominal Pipe Size	Dia. of Bore (mm)			Outside Dia. (mm)	Thickness Min. (mm)	Length Thru. Hub (mm)	Outside Dia. of Neck (mm)	Dia. at Base of Neck (mm)	Dia. of Raised Face (mm)	Height of Raised Face (mm)	Number of Bolt Holes	Dia. of Bolt Holes (mm)	Dia. of Bolt Circle (mm)	Approx. Weight (KG)
	Sch 40	Sch 80	Sch 160											
	do			C	t	H	A	M	G	f		h	D	
1/2"	15.8	13.9	11.7	133.4	30.2	73.2	21.3	42.9	35.1	6.4	4	22.4	88.9	3.2
3/4"	20.9	18.8	15.5	139.7	31.8	79.2	26.7	50.8	42.9	6.4	4	22.4	95.3	3.8
1"	26.6	24.5	20.7	158.8	35.1	88.9	33.4	57.2	50.8	6.4	4	25.4	108.0	5.3
1.1/4"	35.1	32.5	29.4	184.2	38.1	95.3	42.2	73.2	63.5	6.4	4	28.4	130.0	7.9
1.1/2"	40.9	38.1	34.1	203.2	44.5	111.3	48.3	79.2	73.2	6.4	4	31.8	146.1	11.0
2"	52.7	49.5	43.1	235.0	50.8	127.0	60.3	95.3	91.9	6.4	8	28.4	171.5	16.3
2.1/2"	62.7	59.0	54.2	266.7	57.2	142.7	73.0	114.3	104.6	6.4	8	31.8	196.9	23.9
3"	77.9	73.7	66.7	304.8	66.5	168.1	88.9	133.4	127.0	6.4	8	35.1	228.6	37.2
4"	102.3	97.2	87.3	355.6	76.2	190.5	114.3	165.1	157.2	6.4	8	41.1	273.1	55.7
5"	128.2	122.3	109.4	419.1	91.9	228.6	141.2	203.2	185.7	6.4	8	47.8	323.9	92.7
6"	154.2	146.3	131.8	482.6	108.0	273.1	168.4	235.0	215.9	6.4	8	53.8	368.3	143.4
8"	202.7	193.7	173.2	552.5	127.0	317.5	219.2	304.8	269.7	6.4	12	53.8	438.2	215.5
10"	254.5	242.8	215.8	673.1	165.1	419.1	273.0	374.7	323.9	6.4	12	66.5	539.8	409.9
12"	303.2	288.8	257.2	762.0	184.2	463.6	323.8	441.5	381.0	6.4	12	73.2	619.3	584.1

WELDING NECK FLANGE

Forged Stainless Steel Flanges - ANSI

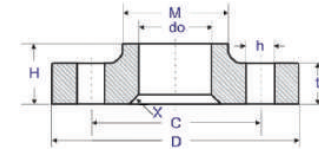

ANSI /ASTM STANDARD - 150# SOLJ

SLIP-ON LAP JOINT FLANGE

Nominal Pipe Size	Outside Dia. (mm)	Dia. of Bore (mm)	Thickness Min. (mm)	Length Thru. Hub (mm)	Radius of Filler (mm)	Dia. at Base of Hub (mm)	Number of Bolt Holes	Dia. of Bolt Holes (mm)	Dia. of Bolt Circle (mm)	Approx. Weight (KG)
	D	do	t	H	X	M		h	C	
1/2"	88.9	22.9	11.2	15.7	3.0	30.2	4	15.7	60.5	0.4
3/4"	98.6	28.2	12.7	15.7	3.0	38.1	4	15.7	69.9	0.6
1"	108.0	35.1	14.2	17.5	3.0	49.3	4	15.7	79.2	0.8
1.1/4"	117.3	43.7	15.7	20.6	4.8	58.7	4	15.7	88.9	1.0
1.1/2"	127.0	50.0	17.5	22.4	6.4	65.0	4	15.7	98.6	1.3
2"	152.4	62.5	19.1	25.4	7.9	77.7	4	19.1	120.7	2.0
2.1/2"	177.8	75.4	22.4	28.4	7.9	90.4	4	19.1	139.7	3.3
3"	190.5	91.4	23.9	30.2	9.7	108.0	4	19.1	152.4	3.8
3.1/2"	215.9	104.1	23.9	31.8	9.7	122.2	8	19.1	177.8	4.8
4"	228.6	116.8	23.9	33.3	11.2	134.9	8	19.1	190.5	5.3
5"	254.0	144.5	23.9	36.6	11.2	163.6	8	22.4	215.9	6.1
6"	279.4	171.5	25.4	39.6	12.7	192.0	8	22.4	241.3	7.4
8"	342.9	222.3	28.4	44.5	12.7	246.1	8	22.4	298.5	12.1
10"	406.4	277.4	30.2	49.3	12.7	304.8	12	25.4	362.0	16.4
12"	482.6	328.2	31.8	55.6	12.7	365.3	12	25.4	431.8	27.0
14"	533.4	360.2	35.1	79.2	12.7	400.1	12	28.4	476.3	35.0
16"	596.9	411.2	36.6	87.4	12.7	457.2	16	28.4	539.8	45.0
18"	635.0	462.3	39.6	96.8	12.7	505.0	16	31.8	577.9	49.0
20"	698.5	514.4	42.9	103.1	12.7	558.8	20	31.8	635.0	62.0
24"	812.8	616.0	47.8	111.3	12.7	663.4	20	35.1	749.3	87.0

ANSI /ASTM STANDARD - 300# SOLJ

SLIP-ON LAP JOINT FLANGE

Nominal Pipe Size	Outside Dia. (mm)	Dia. of Bore (mm)	Thickness Min. (mm)	Length Thru. Hub (mm)	Radius of Filler (mm)	Dia. at Base of Hub (mm)	Number of Bolt Holes	Dia. of Bolt Holes (mm)	Dia. of Bolt Circle (mm)	Approx. Weight (KG)
	D	do	t	H	X	M		h	C	
1/2"	95.2	22.9	14.2	22.3	3.0	38.1	4	15.7	66.5	0.7
3/4"	117.3	28.2	15.7	25.4	3.0	47.7	4	19.0	82.5	1.1
1"	123.9	35.0	17.5	26.9	3.0	53.8	4	19.0	88.9	1.4
1.1/4"	133.3	43.7	19.0	26.9	4.8	63.5	4	19.0	98.5	1.7
1.1/2"	155.4	50.0	20.6	30.2	6.4	69.8	4	22.3	114.3	2.5
2"	165.1	62.5	22.3	33.2	7.8	84.0	8	19.0	127.0	2.9
2.1/2"	190.5	75.4	25.4	38.1	7.8	100.0	8	22.3	149.3	4.3
3"	209.5	91.4	28.4	42.9	9.6	117.3	8	22.3	168.1	5.8
3.1/2"	228.6	104.1	30.2	44.4	9.6	133.3	8	22.3	184.1	7.3
4"	254.0	116.8	31.7	47.7	11.1	146.0	8	22.3	200.1	10.0
5"	279.4	144.5	35.0	50.8	11.1	177.8	8	22.3	234.9	12.2
6"	317.5	171.4	36.5	52.3	12.7	206.2	12	22.3	269.7	15.5
8"	381.0	222.2	41.1	61.9	12.7	260.3	12	25.4	330.2	24.1
10"	444.5	277.4	47.9	95.2	12.7	320.5	16	28.4	387.3	34.4
12"	520.7	328.2	50.8	101.6	12.7	374.6	16	31.7	450.8	51.0
14"	584.2	360.2	53.8	111.2	12.7	425.4	20	31.7	514.3	71.0
16"	647.7	411.2	57.1	120.6	12.7	482.6	20	35.0	571.5	90.0
18"	711.2	462.3	60.4	130.0	12.7	533.4	24	35.0	628.6	111.0
20"	774.7	514.3	63.5	139.7	12.7	587.2	24	35.0	685.8	137.0
24"	914.4	615.9	69.8	152.4	12.7	701.5	24	41.1	812.8	204.0

SLIP-ON LAP JOINT FLANGE

Forged Stainless Steel Flanges – ANSI

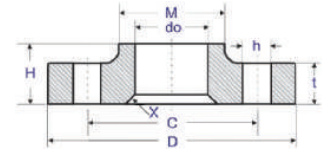

ANSI /ASTM STANDARD – 600# SOLJ

SLIP-ON LAP JOINT FLANGE

Nominal Pipe Size	Outside Dia. (mm)	Dia. of Bore (mm)	Thickness Min. (mm)	Length Thru. Hub (mm)	Radius of Filler (mm)	Dia. at Base of Hub (mm)	Number of Bolt Holes	Dia. of Bolt Holes (mm)	Dia. of Bolt Circle (mm)	Approx. Weight (KG)
	D	do	t	H	X	M		h	C	
1/2"	95.3	22.9	14.2	22.4	3.0	38.1	4	15.7	66.5	0.8
3/4"	117.3	28.2	15.7	25.4	3.0	47.8	4	19.1	82.6	1.3
1"	124.0	35.1	17.5	26.9	3.0	53.8	4	19.1	88.9	1.5
1.1/4"	133.4	43.7	20.6	28.4	4.8	63.5	4	19.1	98.6	2.0
1.1/2"	155.4	50.0	22.4	31.8	6.4	69.9	4	22.4	114.3	2.9
2"	165.1	62.5	25.4	36.6	7.9	84.1	8	19.1	127.0	3.6
2.1/2"	190.5	75.4	28.4	41.1	7.9	100.1	8	22.4	149.4	5.3
3"	209.6	91.4	31.8	46.0	9.7	117.3	8	22.4	168.1	7.0
3.1/2"	228.6	104.1	35.1	49.3	9.7	133.4	8	25.4	184.2	9.0
4"	273.1	116.8	38.1	53.8	11.2	152.4	8	25.4	215.9	14.4
5"	330.2	144.5	44.5	60.5	11.2	189.0	8	28.6	266.7	24.3
6"	355.6	171.5	47.8	66.5	12.7	222.3	12	28.6	292.1	28.5
8"	419.1	222.3	55.6	76.2	12.7	273.1	12	31.8	349.3	43.1
10"	508.0	277.4	63.5	111.3	12.7	342.9	16	35.1	431.8	70.5
12"	558.8	328.2	66.5	117.3	12.7	400.1	20	35.1	489.0	87.0
14"	603.3	360.2	69.9	127.0	12.7	431.8	20	38.1	527.1	100.0
16"	685.8	411.2	76.2	139.7	12.7	495.3	20	41.1	603.3	145.0
18"	743.0	462.3	82.6	152.4	12.7	546.1	20	44.5	654.1	177.0
20"	812.8	514.4	88.9	165.1	12.7	609.6	24	44.5	723.9	225.0
24"	939.8	616.0	101.6	184.1	12.7	717.5	24	50.8	838.2	318.0

ANSI /ASTM STANDARD – 900# SOLJ

SLIP-ON LAP JOINT FLANGE

Nominal Pipe Size	Outside Dia. (mm)	Dia. of Bore (mm)	Thickness Min. (mm)	Length Thru. Hub (mm)	Radius of Filler (mm)	Dia. at Base of Hub (mm)	Number of Bolt Holes	Dia. of Bolt Holes (mm)	Dia. of Bolt Circle (mm)	Approx. Weight (KG)
	D	do	t	H	X	M		h	C	
1/2"	120.6	22.9	22.3	31.7	3.0	38.1	4	22.3	82.5	1.8
3/4"	130.0	28.2	25.4	35.0	3.0	44.4	4	22.3	88.9	2.3
1"	149.3	35.0	28.4	41.1	3.0	52.3	4	25.4	101.6	3.4
1.1/4"	158.7	43.7	28.4	41.1	4.8	63.5	4	25.4	111.2	3.9
1.1/2"	177.8	50.0	31.7	44.4	6.4	69.8	4	28.4	123.9	5.3
2"	215.9	62.5	38.1	57.1	7.8	104.6	8	25.4	165.1	10.0
2.1/2"	244.3	75.4	41.1	63.5	7.8	123.9	8	28.4	190.5	14.0
3"	241.3	91.4	38.1	53.8	9.6	127.0	8	25.4	190.5	11.3
4"	292.1	116.8	44.4	69.8	11.1	158.7	8	31.7	234.9	19.2
5"	349.2	144.5	50.8	79.2	11.1	190.5	8	35.7	279.4	31.2
6"	381.0	171.4	55.6	85.8	12.7	234.9	12	31.7	317.5	40.5
8"	469.9	222.2	63.5	114.3	12.7	298.4	12	38.1	393.7	71.5
10"	546.1	277.4	69.8	127.0	12.7	368.3	16	38.1	469.9	104.0
12"	609.6	328.2	79.2	142.7	12.7	419.1	20	38.1	533.4	139.0
14"	641.3	360.2	85.8	155.4	12.7	450.8	20	41.1	558.8	161.0
16"	704.8	411.2	88.9	165.1	12.7	508.0	20	44.4	615.9	194.0
18"	787.4	462.3	101.6	190.5	12.7	565.1	20	50.8	685.8	267.0
20"	857.2	514.3	107.9	209.5	12.7	622.3	20	53.8	749.3	334.0
24"	1041.4	615.9	139.7	266.7	12.7	749.3	20	66.5	901.7	618.0

SLIP-ON LAP JOINT FLANGE

Forged Stainless Steel Flanges - ANSI

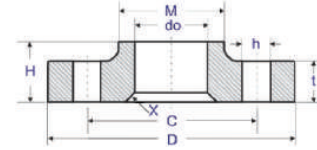

ANSI /ASTM STANDARD - 1500# SOLJ

SLIP-ON LAP JOINT FLANGE

Nominal Pipe Size	Outside Dia. (mm)	Dia. of Bore (mm)	Thickness Min. (mm)	Length Thru. Hub (mm)	Radius of Filler (mm)	Dia. at Base of Hub (mm)	Number of Bolt Holes	Dia. of Bolt Holes (mm)	Dia. of Bolt Circle (mm)	Approx. Weight (KG)
	D	do	t	H	X	M		h	C	
1/2"	120.6	22.9	22.3	31.7	3.0	38.1	4	22.3	82.5	1.8
3/4"	130.0	28.2	25.4	35.0	3.0	44.4	4	22.3	88.9	2.3
1"	149.3	35.0	28.4	41.1	3.0	52.3	4	25.4	101.6	3.4
1.1/4"	158.7	43.7	28.4	41.1	4.8	63.5	4	25.4	111.2	3.9
1.1/2"	177.8	50.0	31.7	44.4	6.4	69.8	4	28.4	123.9	5.3
2"	215.9	62.5	38.1	57.1	7.8	104.6	8	25.4	165.1	10.0
2.1/2"	244.3	75.4	41.1	63.5	7.8	123.9	8	28.4	190.5	14.0
3"	266.7	91.4	47.7	73.1	9.6	133.3	8	31.7	203.2	18.0
4"	311.1	116.8	53.8	90.4	11.1	162.0	8	35.0	241.3	28.0
5"	374.6	144.5	73.1	104.6	11.1	196.8	8	41.1	292.1	52.0
6"	399.7	171.4	82.5	119.1	12.7	228.6	12	38.1	317.5	62.0
8"	482.6	222.2	91.9	142.7	12.7	292.1	12	44.4	393.7	105.0
10"	584.2	277.4	107.9	177.8	12.7	368.3	12	50.8	482.6	179.0
12"	673.1	328.2	123.9	218.9	12.7	450.8	16	53.8	571.5	269.0
14"	749.3	360.2	133.3	241.3	12.7	495.3	16	60.4	635.0	365.0
16"	825.5	411.2	146.0	260.3	12.7	552.4	16	66.5	704.8	459.0
18"	914.4	462.3	162.0	276.2	12.7	596.9	16	73.1	774.7	598.0
20"	984.2	514.3	177.8	292.1	12.7	641.3	16	79.2	831.8	712.0
24"	1168.4	615.9	203.2	330.2	12.7	762.0	16	91.9	990.6	1090.0

ANSI /ASTM STANDARD - 2500# SOLJ

SLIP-ON LAP JOINT FLANGE

Nominal Pipe Size	Outside Dia. (mm)	Dia. of Bore (mm)	Thickness Min. (mm)	Length Thru. Hub (mm)	Radius of Filler (mm)	Dia. at Base of Hub (mm)	Number of Bolt Holes	Dia. of Bolt Holes (mm)	Dia. of Bolt Circle (mm)	Approx. Weight (KG)
	D	do	t	H	X	M		h	C	
1/2"	133.4	22.9	30.2	39.6	3.0	42.9	4	22.4	88.9	3.0
3/4"	139.7	28.2	31.8	42.9	3.0	50.8	4	22.4	95.3	3.5
1"	158.8	35.1	35.1	47.8	3.0	57.2	4	25.4	108.0	4.8
1.1/4"	184.2	43.7	38.1	52.3	4.8	73.2	4	28.4	130.0	7.1
1.1/2"	203.2	50.0	44.5	60.5	6.4	79.2	4	31.8	146.1	10.0
2"	235.0	62.5	50.8	69.9	7.9	95.3	8	28.4	171.5	14.7
2.1/2"	266.7	75.4	57.2	79.2	7.9	114.3	8	31.8	196.9	22.0
3"	304.8	91.4	66.5	91.9	9.7	133.4	8	35.1	228.6	33.0
4"	355.6	116.8	76.2	107.9	11.2	165.1	8	41.1	273.1	53.0
5"	419.1	144.5	91.9	130.2	11.2	203.2	8	47.8	323.9	83.0
6"	482.6	171.5	108.0	152.4	12.7	235.0	8	53.8	368.3	127.0
8"	552.5	222.3	127.0	177.8	12.7	304.8	12	53.8	438.2	186.0
10"	673.1	277.4	165.1	228.6	12.7	374.7	12	66.5	539.8	352.0
12"	762.0	328.2	184.2	254.0	12.7	441.5	12	73.2	619.3	501.0

SLIP-ON LAP JOINT FLANGE

Forged Stainless Steel Flanges – ANSI

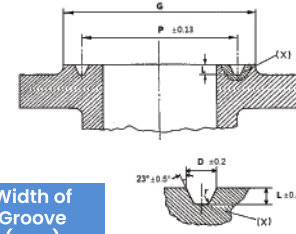

ANSI /ASTM STANDARD – 150# RING JOINT DIMENSIONS

Nominal Pipe Size	Raised Face Ring Joint (mm)	Pitch Diameter Groove (mm)	Depth of Groove (mm)	Radius at Bottom (mm)	Width of Groove (mm)
	G	P	L	r	D
1"	63.5	47.6	6.35	0.8	8.7
1.1/4"	73.2	57.2	6.35	0.8	8.7
1.1/2"	82.5	65.1	6.35	0.8	8.7
2"	101.6	82.6	6.35	0.8	8.7
2.1/2"	120.7	101.6	6.35	0.8	8.7
3"	133.4	114.3	6.35	0.8	8.7
3.1/2"	153.9	131.8	6.35	0.8	8.7
4"	171.5	149.2	6.35	0.8	8.7
5"	193.5	171.5	6.35	0.8	8.7
6"	218.9	193.7	6.35	0.8	8.7
8"	273.1	247.7	6.35	0.8	8.7
10"	330.2	304.8	6.35	0.8	8.7
12"	406.4	381.0	6.35	0.8	8.7
14"	425.5	396.9	6.35	0.8	8.7
16"	482.6	454.0	6.35	0.8	8.7
18"	546.1	517.5	6.35	0.8	8.7
20"	596.9	558.8	6.35	0.8	8.7
24"	711.2	673.1	6.35	0.8	8.7

ANSI /ASTM STANDARD – 300-600# RING JOINT DIMENSIONS

Nominal Pipe Size	Raised Face Ring Joint (mm)	Pitch Diameter Groove (mm)	Depth of Groove (mm)	Radius at Bottom (mm)	Width of Groove (mm)
	G	P	L	r	D
1/2"	50.8	34.1	5.60	0.8	7.1
3/4"	63.5	42.9	6.35	0.8	8.7
1"	69.9	50.8	6.35	0.8	8.7
1.1/4"	79.2	60.3	6.35	0.8	8.7
1.1/2"	90.4	68.3	6.35	0.8	8.7
2"	108.0	82.6	7.90	0.8	11.9
2.1/2"	127.0	101.6	7.90	0.8	11.9
3"	146.1	123.8	7.90	0.8	11.9
3.1/2"	158.8	131.8	7.90	0.8	11.9
4"	174.8	149.2	7.90	0.8	11.9
5"	209.5	181.0	7.90	0.8	11.9
6"	241.3	211.1	7.90	0.8	11.9
8"	301.8	269.9	7.90	0.8	11.9
10"	355.6	323.9	7.90	0.8	11.9
12"	412.8	381.0	7.90	0.8	11.9
14"	457.5	419.1	7.90	0.8	11.9
16"	508.0	469.9	7.90	0.8	11.9
18"	574.5	533.4	7.90	0.8	11.9
20"	635.0	584.2	9.50	1.6	13.5
24"	749.3	692.2	11.10	1.6	16.7

Forged Stainless Steel Flanges – ANSI

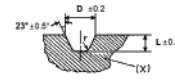
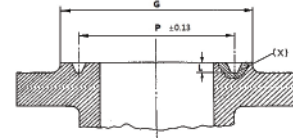

ANSI /ASTM STANDARD – 900#

RING JOINT DIMENSIONS

Nominal Pipe Size	Raised Face Ring Joint (mm)	Pitch Diameter Groove (mm)	Depth of Groove (mm)	Radius at Bottom (mm)	Width of Groove (mm)
	G	P	L	r	D
1/2"	60.5	39.7	6.35	0.8	8.7
3/4"	66.5	44.5	6.35	0.8	8.7
1"	71.4	50.8	6.35	0.8	8.7
1.1/4"	81.0	60.3	6.35	0.8	8.7
1.1/2"	91.9	68.3	6.35	0.8	8.7
2"	124.0	95.3	7.90	0.8	11.9
2.1/2"	136.7	108.0	7.90	0.8	11.9
3"	155.4	123.8	7.90	0.8	11.9
4"	180.8	149.2	7.90	0.8	11.9
5"	215.9	181.0	7.90	0.8	11.9
6"	241.3	211.1	7.90	0.8	11.9
8"	307.8	269.9	7.90	0.8	11.9
10"	362.0	323.9	7.90	0.8	11.9
12"	419.1	381.0	7.90	0.8	11.9
14"	466.9	419.1	11.10	1.5	16.7
16"	523.9	469.9	11.10	1.5	16.7
18"	593.9	533.4	12.70	1.5	19.8
20"	647.7	584.2	12.70	1.5	19.8
24"	771.7	692.2	15.90	2.3	27.0

ANSI /ASTM STANDARD – 1500#

RING JOINT DIMENSIONS

Nominal Pipe Size	Raised Face Ring Joint (mm)	Pitch Diameter Groove (mm)	Depth of Groove (mm)	Radius at Bottom (mm)	Width of Groove (mm)
	G	P	L	r	D
1/2"	60.5	39.7	6.35	0.8	8.7
3/4"	66.5	44.5	6.35	0.8	8.7
1"	71.4	50.8	6.35	0.8	8.7
1.1/4"	81.0	60.3	6.35	0.8	8.7
1.1/2"	91.9	68.3	6.35	0.8	8.7
2"	124.0	95.3	7.9	0.8	11.9
2.1/2"	136.7	108.0	7.9	0.8	11.9
3"	168.1	136.5	7.9	0.8	11.9
4"	193.5	161.9	7.9	0.8	11.9
5"	228.6	193.7	7.9	0.8	11.9
6"	247.7	211.1	9.5	1.6	13.5
8"	317.5	269.9	11.1	1.6	16.7
10"	371.3	323.9	11.1	1.6	16.7
12"	438.2	381.0	14.3	1.6	23.0
14"	489.0	419.1	15.9	2.4	27.0
16"	546.1	469.9	17.5	2.4	30.2
18"	612.6	533.4	17.5	2.4	30.2
20"	673.1	584.2	17.5	2.4	33.3
24"	793.8	692.2	20.6	2.4	36.5

Forged Stainless Steel Flanges – ANSI

ANSI /ASTM STANDARD – 2500# RING JOINT DIMENSIONS

Nominal Pipe Size	Raised Face Ring Joint (mm)	Pitch Diameter Groove (mm)	Depth of Groove (mm)	Radius at Bottom (mm)	Width of Groove (mm)
	G	P	L	r	D
1/2"	65.0	42.9	6.35	0.8	8.7
3/4"	73.2	50.8	6.35	0.8	8.7
1"	82.6	60.3	6.35	0.8	8.7
1.1/4"	101.6	72.2	7.90	0.8	11.9
1.1/2"	114.3	82.6	7.90	0.8	11.9
2"	133.4	101.6	7.90	0.8	11.9
2.1/2"	149.4	111.1	9.50	1.6	13.5
3"	168.1	127.0	9.50	1.6	13.5
4"	203.2	157.2	11.10	1.6	16.7
5"	241.3	190.5	12.70	1.6	19.8
6"	279.4	228.6	12.70	1.6	19.8
8"	339.9	279.4	14.30	1.6	23.0
10"	425.5	342.9	17.50	2.4	30.2
12"	495.3	406.4	17.50	2.4	33.3

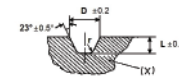
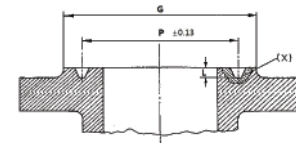

DIMENSIONAL TOLERANCE FOR FLANGES

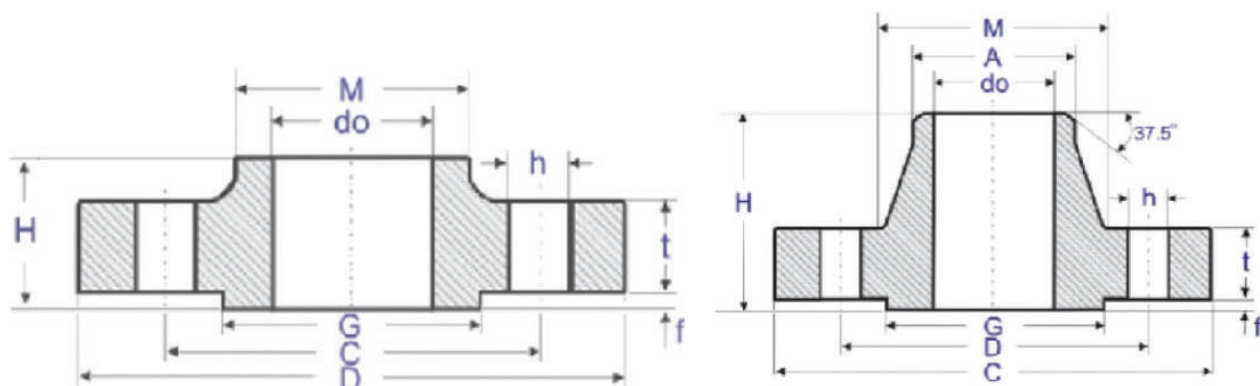

*Others:

SO / LJ / BL / TH / SW

WN

Dimension		Sizes	Tolerances	
			mm (Others)	mm (WN)
do	Inside Diameter	NPS ≤ 10"	+1.0mm, -0.0mm	±1.0mm
		12" ≤ NPS ≤ 18"	+1.6mm, -0.0mm	±1.6mm
		NPS ≥ 20"		±3.2mm, -1.6mm
G	Diameter of Raised Face	Raised face, 0.06" (1.6mm)	±1.0mm	±1.0mm
		Raised face, 0.25" (6.4mm)	±0.5mm	±0.5mm
*M	Diameter of Hub at Base	NPS ≤ 12"	+2.4mm, -1.6mm	-
		NPS ≥ 14"	±3.2mm	-
A	Diameter of Hub at Point of Welding	NPS ≤ 5"	-	+2.0mm, -1.0mm
		NPS ≥ 6"	-	+4.0mm, -1.0mm
C (Others) D (WN)	Bolt Circle Diameter	ALL SIZES	±1.6mm	±1.6mm
h	Bolt Hole Diameter	ALL SIZES	±0.8mm	±0.8mm
H	Length Through Hub	NPS ≤ 2-1/2"	±0.8mm	±0.8mm
		NPS ≥ 3"	±1.6mm	±1.6mm
		NPS ≤ 4"	±1.6mm	±1.6mm
t	Thickness	5" ≤ NPS ≤ 10"	+1.6mm, -3.2mm	+1.6mm, -3.2mm
		NPS ≥ 12"	+3.0mm, -5.0mm	+3.0mm, -5.0mm
		NPS ≤ 18"	+3.0mm, -0.0mm	+3.0mm, -0.0mm
		NPS ≥ 20"	+5.0mm, -0.0mm	+5.0mm, -0.0mm

Notes : *M This dimension is for the large end of the hub, which may be **straight** or **tapered**. **Taper shall not exceed 7 deg** on (Others: SO / LJ / TH / SW) flanges.

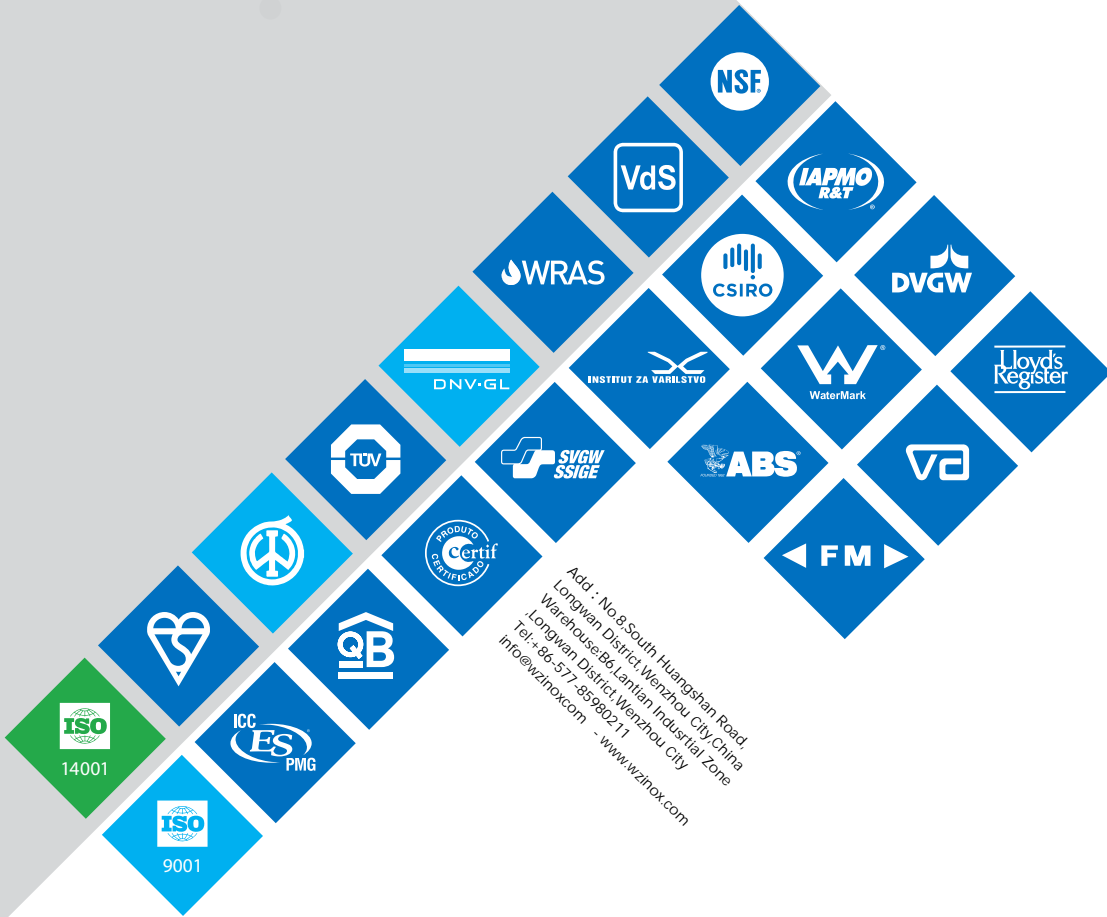

Add : No.8 South Huangshan Road
 Longwan District Wenzhou City,China
 Warehouse:B6, Lanlan Industrial Zone
 Longwan District, Wenzhou City
 Tel: +86-577-85980211
 Info@wzinox.com - www.wzinox.com